

RoHS

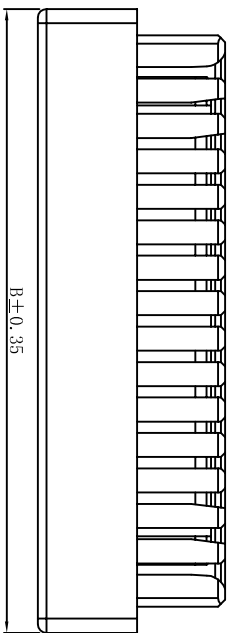

B±0.35

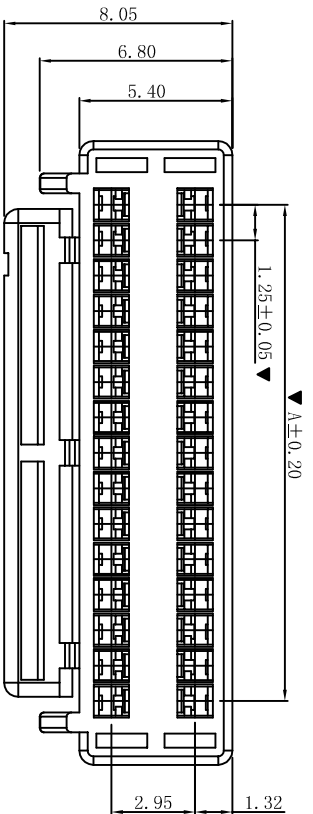

▼A±0.20

1.25±0.05 ▼

1.32

8.05

6.80

5.40

2.95

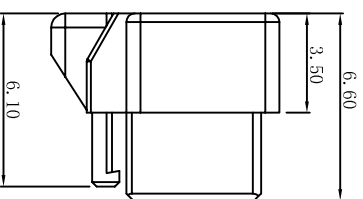

6.60

3.50

6.10

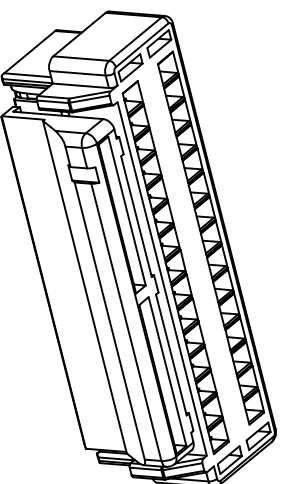
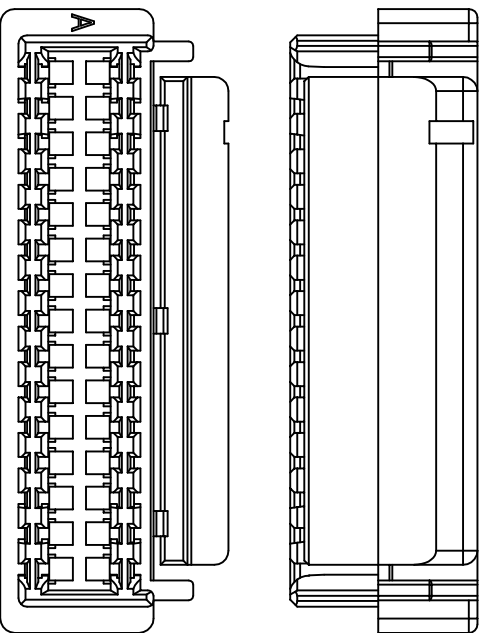

PART NO.	Dimension mm	
	A	B
2x5P	5.00	9.50
2x6P	6.25	10.75
2x7P	7.50	12.00
2x8P	8.75	13.25
2x9P	10.00	14.50
2x10P	11.25	15.75
2x11P	12.50	17.00
2x12P	13.75	18.25
2x13P	15.00	19.50
2x14P	16.25	20.75
2x15P	17.50	22.00
2x16P	18.75	23.25
2x17P	20.00	24.50
2x18P	21.25	25.75
2x19P	22.50	27.00
2x20P	23.75	28.25

■ SPECIFICATIONS

- Voltage rating: 50V AC, DC
- Current rating: 1A, AC, DC
- Withstanding Voltage: 500V AC/minute
- Insulation resistance: 100MΩ min
- Temperature range: -25°C~+85°C

■ HOUSING

- Part No.: HI258-2xNP
- Poles: 10-40P
- Housing Material: PA66 UL94V-0
- The Dimension Marked "▼" Must Be Recorded

一般公差 GENERAL TOLERANCE:	0±0.30 .0±0.25 .000±0.05
ANGLE: ±1°	

绘图/DR	陈雄军
审核/CHECK	胡进
批准/APPRO	

XYDZ® 东莞市祥运连接器有限公司  
Dongguan XiangYun Connector s CO., Ltd

GHD1.25mm Male Housing

Connector Series

料号 (PART NO) HI258-2xNP

状态码 C

投影法 Projection	第一角
单位 Unit	MM
比例/Scale	1:1
大小/Size	A4
页码/SHEET	1/1
版本/Rev	A

一般公差 GENERAL TOLERANCE:	0±0.30 .0±0.25 .000±0.05
ANGLE: ±1°	

绘图/DR	陈雄军
审核/CHECK	胡进
批准/APPRO	

日期/DATE	2022-07-12
承认 APPRO.	陈雄军

说明 DESCRIPTION	新版本
-------------------	-----

版次 REV.	A
---------	---

1 2 3 4 5 6 7 8 9 10

RoHS

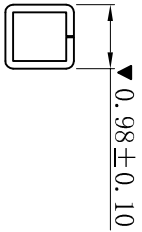
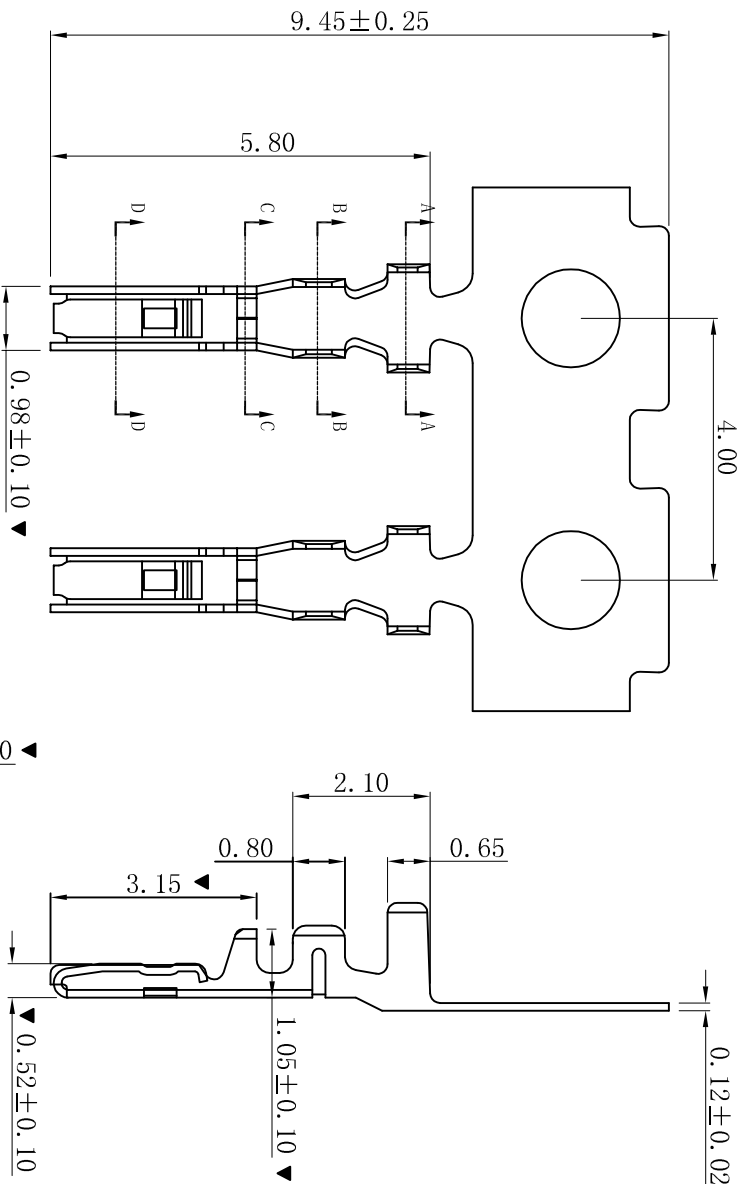

SECTION: C-C

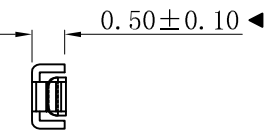

SECTION: D-D

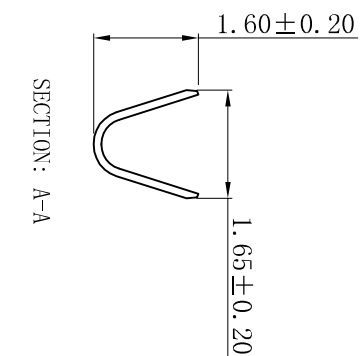

SECTION: A-A

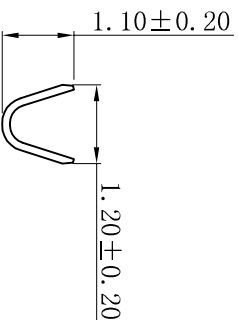

SECTION: B-B

- SPECIFICATIONS
- Voltage rating: 50V AC, DC
  - Current rating: 1A, AC, DC
  - Withstanding Voltage: 500V AC/minute
  - Temperature range: -25° C~+85° C
  - Contact resistance: 50mΩ max
- TERMINAL
- Part No. : T1258PT
  - Applicable wire: AWG#26-#32
  - Material: Phosphor Bronze
  - Finish: Tin plated or Gold-Flash
  - The Dimension Marked "▼" Must Be Recorded

一般公差	0±0.30
GENERAL TOLERANCE:	.00±0.25
	.000±0.05
ANGLE: ±1°	

绘图/DR	陈雄军
审核/CHECK	胡进
批准/APPRO	

日期/DATE	2022-07-12
承认/APPRO.	陈雄军
说明/DESCRIPTION	新版本
版次/REV.	1

**XYDZ® 东莞市祥运连接器有限公司**  
 Dongguan XiangYun Connector s CO., Ltd

品名 (PART NAME) GHD1.25mm Female Terminal  
 Connector Series

投影法 Projection	第一角法
单位 Unit	MM
比例/Scale	1:1
大小/SIZE	A4
页码/SHEET	1/1
版本/Rev	A
料号 (PART NO)	T1258PT
状态码	C