

W4202VTD-2xNP-X X-P1-HF

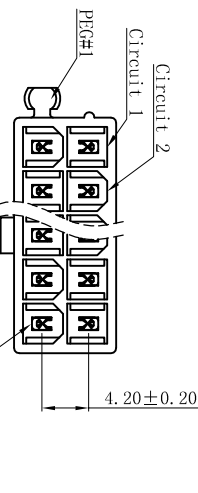

HSG Material / Color
 LP: LCP-V0 Natural
 LPBK: LCP-V0 Black
 9T: PA9T-V0 Natural
 9T1BK: PA9T-V0 Black

Contact Finish
 None: Tin-Plated
 Tin Thickness=100u"
 Nickel Thickness=50u"
 SW: Matte Tin-Plated
 G: Gold-Flash
 G3: 3u" Gold
 G10: 10u" Gold
 G15: 15u" Gold

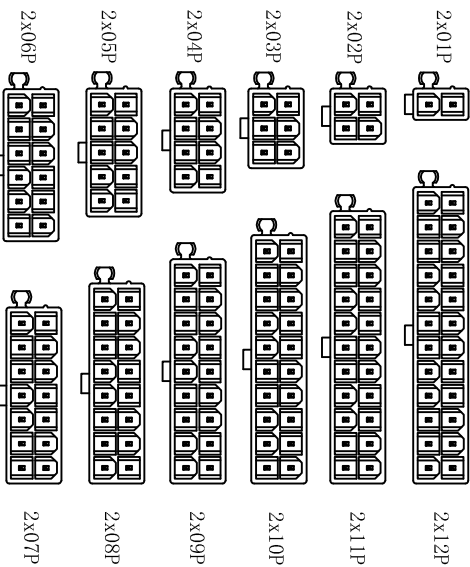
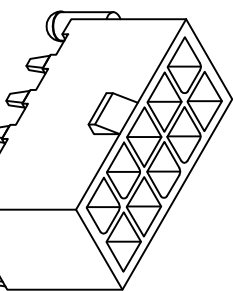
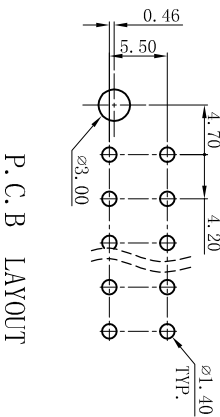
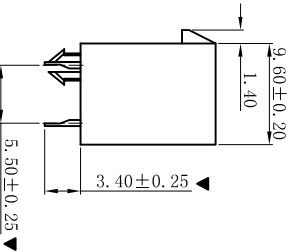
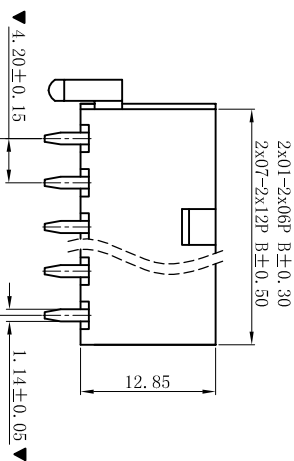

CIRCUIT SIZE LAYOUT

- SPECIFICATIONS**
- Voltage rating: 600V AC, DC
 - Current rating: 7A, AC, DC
 - Withstanding Voltage: 1500V AC/minute
 - Insulation resistance: 1000MΩ min
 - Temperature range: -25° C~+85° C
 - Contact resistance: 20mΩ max
- WAFER**
- Part No.: W4202VTD-2xNP-XX-P1-HF
 - Poles : 02-24P
 - Housing Material: High Temperature Materials
UL94V-0 Halogen Free
 - Pin Material: Brass
 - Contact Area Plating: Tin-Plated or Gold-Flash
 - Mates With: H4201 dual row receptacle
 - The Dimension Marked "▼" Must Be Recorded

PART NO.	Dimensions (mm)	
	A	B
2x01	---	5.60
2x02	4.20	9.80
2x03	8.40	14.00
2x04	12.60	18.20
2x05	16.80	22.40
2x06	21.00	26.60
2x07	25.20	30.80
2x08	29.40	35.00
2x09	33.60	39.20
2x10	37.80	43.40
2x11	42.00	47.60
2x12	46.20	51.80

XYDZ® 东莞市祥运连接器有限公司
 Dongguan XiangYun Connectors CO., Ltd

一般公差 GENERAL TOLERANCE:	0±0.30 .00±0.25 .000±0.05
ANGLE: ±1°	

投影法 Projection	第一角投影
单位 Unit	MM
比例/Scale	1:1
大小/Size	A4
页码/Sheet	1/1
版本/Rev	B

品名 (PART NAME)	Molex 4.20mm 180° 单边柱 Wafer Connector Series
料号 (PART NO)	W4202VTD-2xNP-XX-P1-HF

更新图面	2019-07-03	PP: Duuu
新版本	2019-04-13	PP: Duuu
说明	日期	承认
DESCRIPTION	DATE:	APPRO.

版次 REV.	1	2	3	4	5	6	7	8	9	10
------------	---	---	---	---	---	---	---	---	---	----