

RoHS

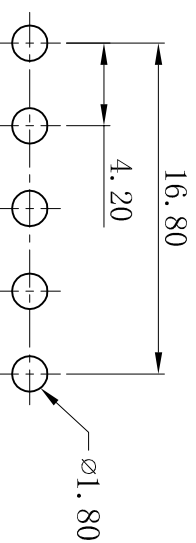
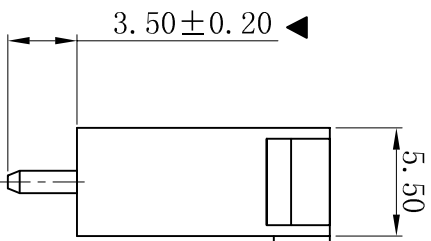
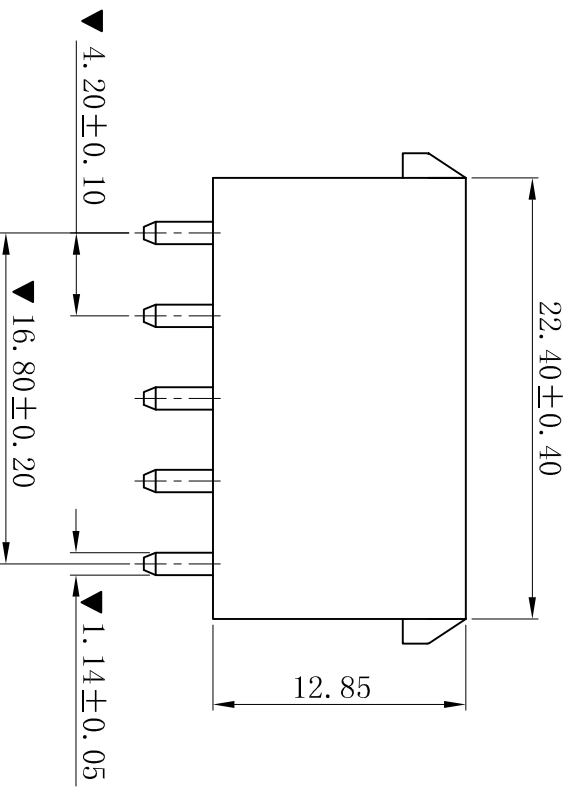
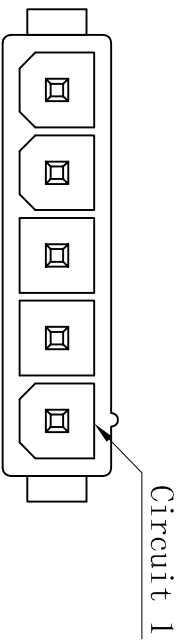

P. C. B LAYOUT

■ SPECIFICATIONS

- Voltage rating: 600V AC, DC
- Current rating: 7A, AC, DC
- Withstanding Voltage: 1500V AC/minute
- Insulation resistance: 1000MΩ min
- Temperature range: -25° C~+85° C
- Contact resistance: 20mΩ max

■ WAFER

- Part No.: W4202VLCB-1x05P-BK
 - Poles: 05P
 - Housing Material: PA66 UL94V-2 Black
 - Pin Material: Brass
 - Contact Area Plating: Tin-Plated
- The Dimension Marked “▼” Must Be Recorded

一般公差 GENERAL TOLERANCE:		0±0.30 .0±0.25 .000±0.20
绘图/DR		P.P. Duwa
审核/CHECK		陈雄军
批准/APPRO		胡进
日期/DATE		2019-07-03

更新图面	2019-07-03	P.P. Duwa
新版本	2019-01-12	P.P. Duwa
说明	日期	承认
DESCRIPTION	DATE	APPRO.

投影法	第一角
单位 Unit	MM
比例/Scale	1:1
大小/Size	A4
页码/SHEET	1/1
版本/Rev	B

XYDZ® 东莞市祥运连接器有限公司 Dongguan XiangYun Connectors CO., Ltd	
品名 (PART NAME)	Molex 4.20mm 180° 侧边双卡扣 Wafer Connector Series
料号 (PART NO)	W4202VLCB-1x05P-BK
状态码	C

版次 REV.	1	2	3	4	5	6	7	8	9	10
------------	---	---	---	---	---	---	---	---	---	----