

RoHS

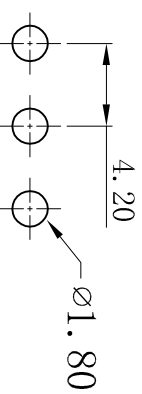
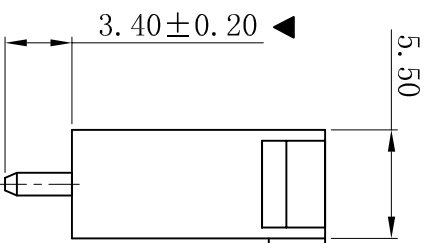
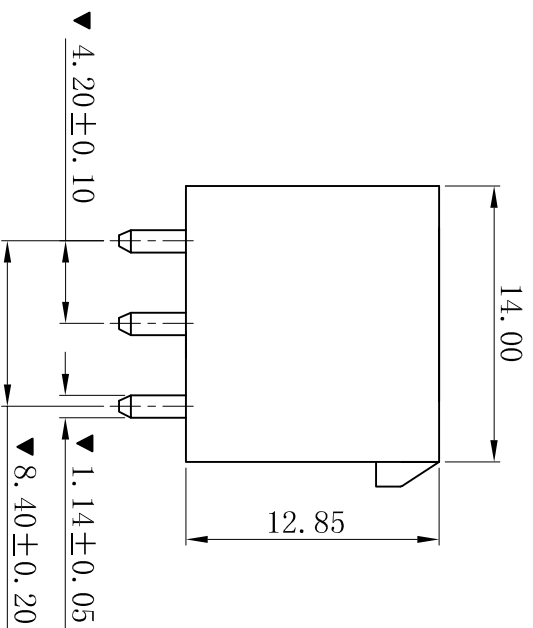
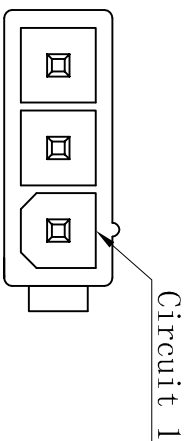

P. C. B LAYOUT

- SPECIFICATIONS
- Voltage rating: 600V AC, DC
 - Current rating: 7A, AC, DC
 - Withstanding Voltage: 1500V AC/minute
 - Insulation resistance: 1000MΩ min
 - Temperature range: -25° C~+85° C
 - Contact resistance: 20mΩ max
- WAFER
- Part No.: W4202VCB-1x03P-BK
 - Poles: 03P
 - Housing Material: PA66 UL94V-2 Black
 - Pin Material: Brass
 - Contact Area Plating: Tin-Plated
 - Mates With: H4201 Single row receptacle
 - The Dimension Marked “▼” Must Be Recorded

更新图面		2019-07-03	陈雄军	一般公差 GENERAL TOLERANCE:		0±0.30 .0±0.25 .000±0.20 ANGLE: ±1°	XYDZ® 东莞市祥运连接器有限公司 Connectors Dongguan XiangYun Connectors CO., Ltd		投影法 Projection		品名 (PART NAME)		料号 (PART NO)		状态码	
修打版本		2015-11-04	陈雄军	绘图/DR		胡进	Molex 4.20mm 180° Wafer Connector Series		单位 Unit		(PART NAME)		(PART NO)		C	
变更图宽格式内容		2013-12-27	陈雄军	审核/CHKC		陈雄军	大小/SIZE		比例/Scale		A4		W4202VCB-1x03P-BK			
新版本		2011-05-24	陈雄军	批准/APPRO		胡进	页码/SHEET		1/1							
说明 DESCRIPTION		日期 DATE:	承认 APPRO.	日期/DATE		2019-07-03	版本/Rev		D							

1 2 3 4 5 6 7 8 9 10