

ROHS

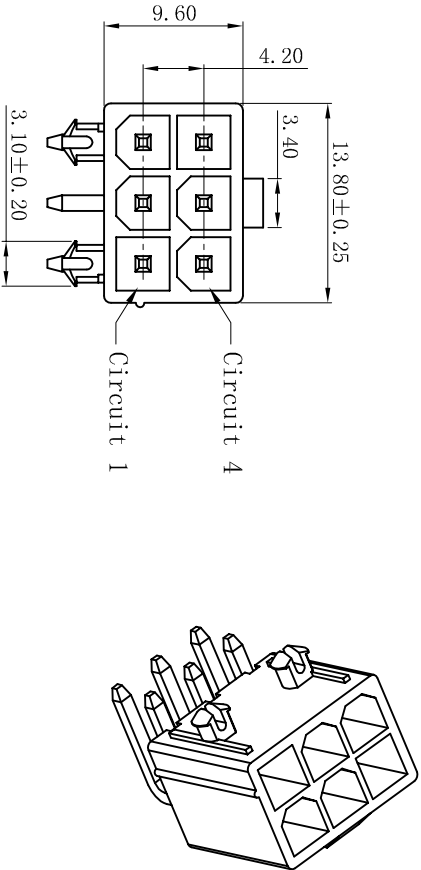

- SPECIFICATIONS
- Voltage rating: 600V AC, DC
 - Current rating: 7A, AC, DC
 - Withstanding Voltage: 1500V AC/minute
 - Insulation resistance: 1000MΩ min
 - Temperature range: -25° C~+85° C
 - Contact resistance: 20mΩ max
- WAFER
- Part No. : W4202RD-2x03P-PCI-6TBK-4-2-WL3.5
 - Poles: 06P
 - Housing Material: PA6T UL94V-0 Black
 - Pin Material: Brass
 - Contact Area Plating: Tin-Plated
 - PIN L=1.07x16.20x24.60
- The Dimension Marked “▼” Must Be Recorded

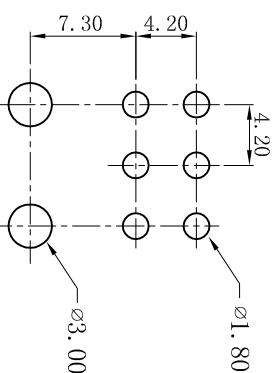
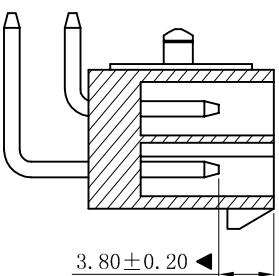
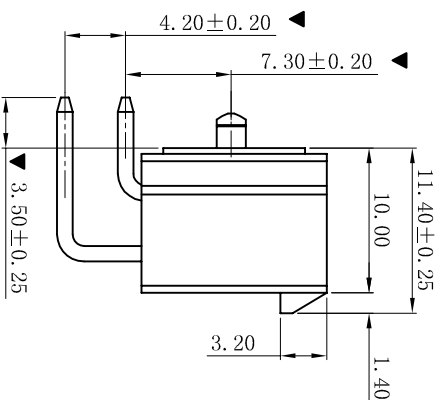
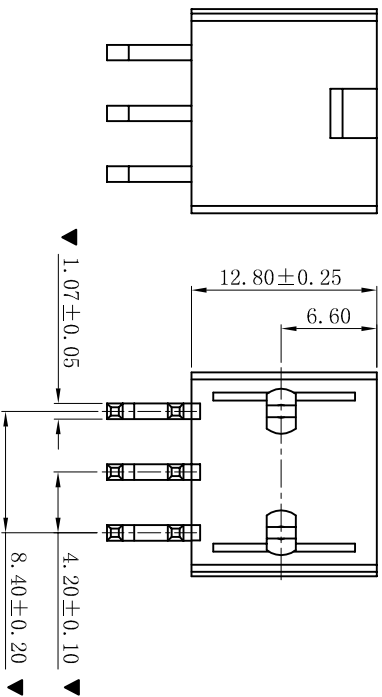

RECOMMEND P.C.B. LAYOUT
TOLERANCE ±0.05
TOP VIEW

D	更新图面	2019-07-03	陈雄军	一般公差 GENERAL TOLERANCE:	0±0.30 .0±0.25 .000±0.05
C	修订版本	2015-11-04	陈雄军	绘图/DR	陈雄军
B	变更图宽格式内容	2013-12-27	陈雄军	审核/CHECK	陈雄军
A	新版本	2011-05-24	陈雄军	批准/APPRO	胡进
H	说明	日期	承认	日期/DATE	2019-07-03
1	版次	说明	承认	日期/DATE	2019-07-03
1	版次	说明	承认	日期/DATE	2019-07-03

XYDZ® 东莞市祥运连接器有限公司
Dongguan XiangYun Connectors CO., Ltd

品名 (PART NAME): Molex 4.20mm 90° PCI防呆 Wafers Connector Series

料号 (PART NO): W4202RD-2x03P-PCI-6TBK-4-2-WL3.5

状态码: C

投影法: 第一角投影
单位: MM
比例/Scale: 1:1
大小/Size: A4
页码/Sheet: 1/1
版本/Rev: D