

ROHS

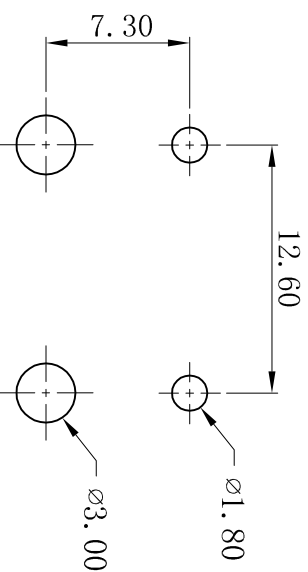
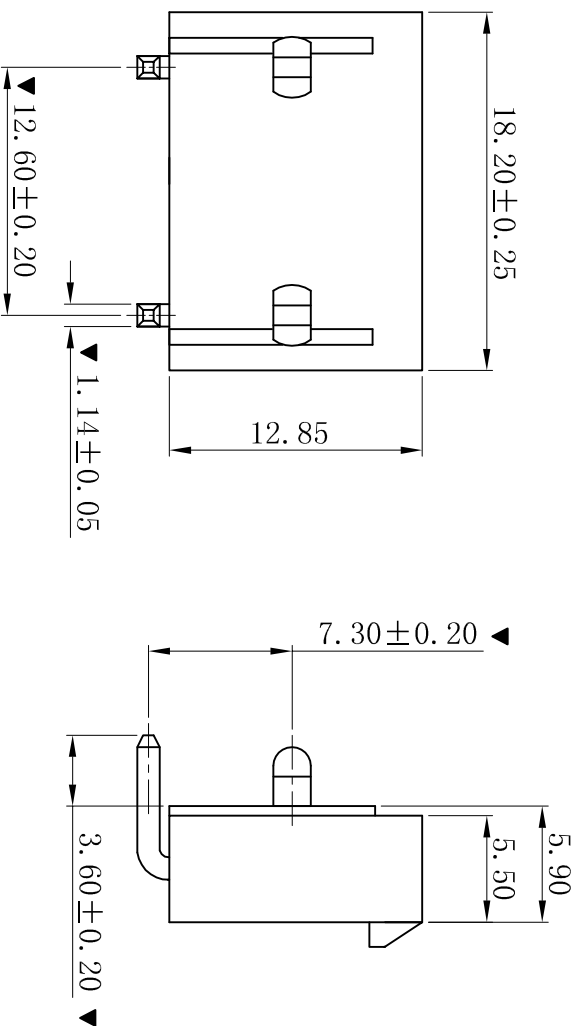
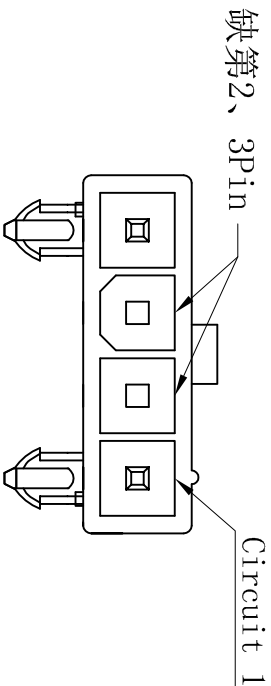

P.C.B LAYOUT

- SPECIFICATIONS**
- Voltage rating: 600V AC, DC
  - Current rating: 7A, AC, DC
  - Withstanding Voltage: 1500V AC/minute
  - Insulation resistance: 1000MΩ min
  - Temperature range: -25° C~+85° C
  - Contact resistance: 20mΩ max
- WAFER**
- Part No.: W4202RD-1x04P-Q2P
  - Poles: 04P
  - Housing Material: PA66 UL94V-2
  - Pin Material: Brass
  - Contact Area Plating: Tin-Plated
  - Mates With: H4201 Single row receptacle
  - The Dimension Marked “▼” Must Be Recorded

|   |          |            |             |
|---|----------|------------|-------------|
| D | 更新图面     | 2019-07-03 | 陈雄军         |
| C | 修訂版本     | 2015-11-04 | 陈雄军         |
| B | 变更图宽格式内容 | 2013-12-27 | 陈雄军         |
| A | 新版本      | 2011-05-24 | 陈雄军         |
| H | 说明       | 日期         | 承认          |
| 1 | 版次       | REV.       | DESCRIPTION |

|                    |            |            |
|--------------------|------------|------------|
| 一般公差               |            | 0±0.30     |
| GENERAL TOLERANCE: |            | .00±0.25   |
|                    |            | .000±0.05  |
| ANGLE: ±1°         |            |            |
| 绘图/DR              | 陈雄军        | 2019-07-03 |
| 审核/CHECK           | 陈雄军        |            |
| 核准/APPRO           | 胡进         |            |
| 日期/DATE            | 2019-07-03 |            |

|  |  |
|--|--|
| <p><b>XYDZ® 东莞市祥运连接器有限公司</b><br/>Dongguan XiangYun Connectors CO., Ltd</p> |  |
| 投影法<br>Projection  | 品名<br>(PART NAME)                              |
| 单位 Unit<br>MM  | Molex4, 20mm 90° 定位柱<br>Wafer Connector Series |
| 比例/Scale<br>1:1  | 料号<br>(PART NO)                                |
| 大小/Size<br>A4  | W4202RD-1x04P-Q2P                              |
| 页码/SHEET<br>1/1  | 状态码  |
| 版本/Rev<br>D  | C  |