

RoHS

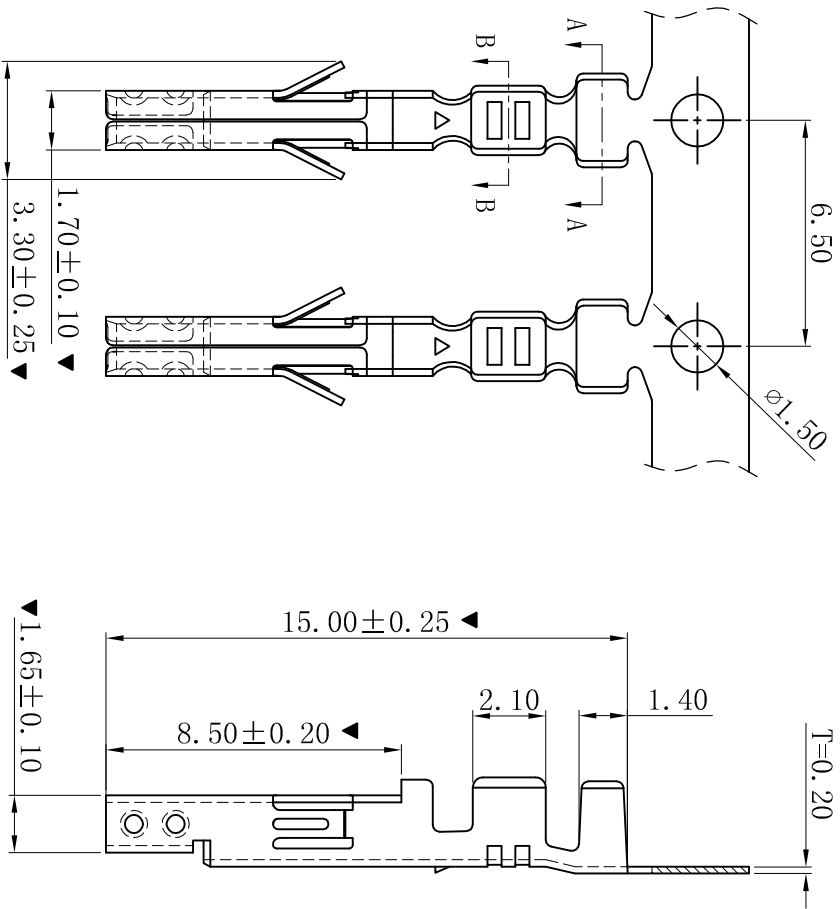

SECTION: A-A

SECTION: B-B

- SPECIFICATIONS
- Voltage rating: 600V AC, DC
- Current rating: 7A, AC, DC
- Withstanding Voltage: 1500V AC/minute
- Temperature range: -25°C~+85°C
- Contact resistance: 20mΩ max
- TERMINAL
- Part No.: T4202BT
- Applicable wire: AWG#20-#24
- Material: Brass or Phosphor Bronze
- Finish: Tin Plated
- The Dimension Marked "▼" Must Be Recorded

| | | | | | | | | | | | | | | | |
|----------|--|-------------|--|--------|--|----------------------------|--|--|--|-------------------|--|-------------------|--|---------------------------|--|
| 更新图面 | | 2019-07-03 | | 陈雄军 | | 一般公差 GENERAL TOLERANCE: | | 0±0.30 .0±0.25 .00±0.20 .000±0.05 | | 投影法 Projection | | 品名 (PART NAME) | | Mollex 4.20mm Female | |
| 修订版本 | | 2018-07-09 | | 陈雄军 | | 绘图/DR | | 陈雄军 | | 单位 Unit | | (PART NAME) | | Terminal Connector Series | |
| 变更图宽格式内容 | | 2013-12-27 | | 陈雄军 | | 审核/CHECK | | 陈雄军 | | 比例/Scale | | 料号 (PART NO) | | T4202BT | |
| 新版本 | | 2011-05-24 | | 陈雄军 | | 批准/APPRO | | 胡进 | | 大小/Size | | A4 | | | |
| 说明 | | 日期 | | 承认 | | 日期/DATE | | 2019-07-03 | | 页码/SHEET | | 1/1 | | | |
| 版次 | | DESCRIPTION | | APPRO. | | 日期/DATE | | 2019-07-03 | | 版本/Rev | | D | | | |
| 1 | | 2 | | 3 | | 4 | | 5 | | 6 | | 7 | | 8 | |
| 1 | | 2 | | 3 | | 4 | | 5 | | 6 | | 7 | | 8 | |

XYDZ® 东莞市祥运连接器有限公司
Dongguan Xiangyun Connector s CO., Ltd

A B C D E F G H 1 2 3 4 5 6 7 8 9 10