

ROHS

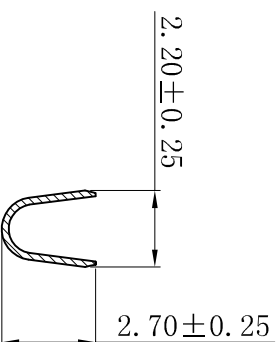
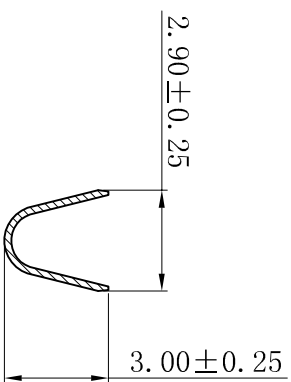
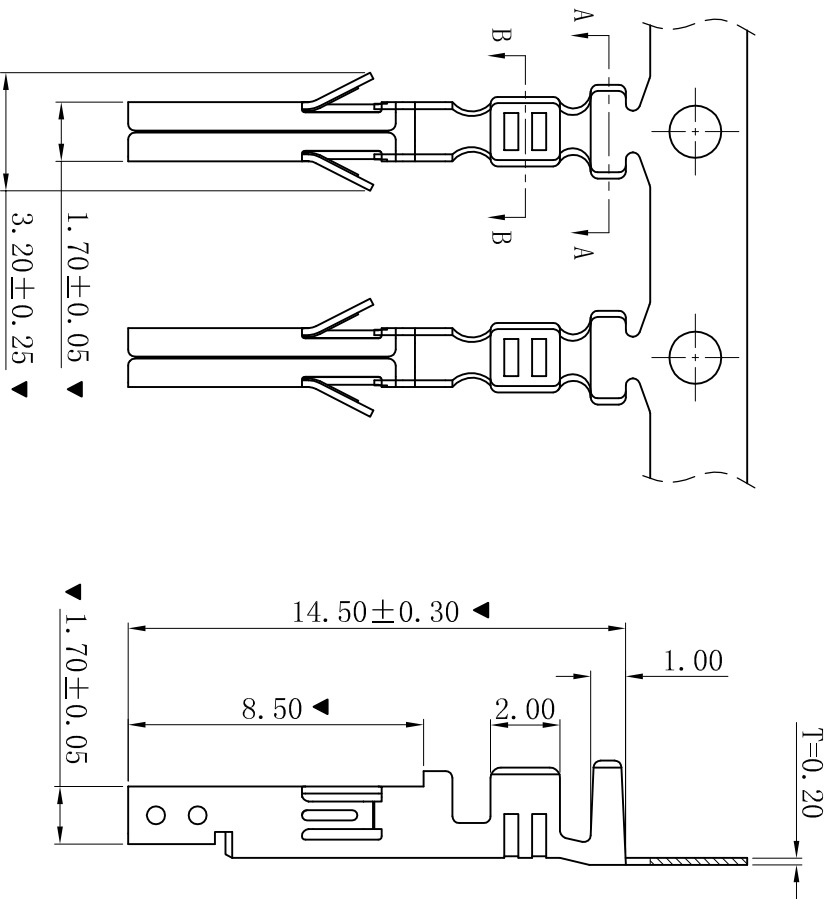

SECTION: A-A

SECTION: B-B

- SPECIFICATIONS
- Voltage rating: 600V AC, DC
 - Current rating: 7A, AC, DC
 - Withstanding Voltage: 1500V AC/minute
 - Temperature range: -25° C~+85° C
 - Contact resistance: 20mΩ max
- TERMINAL
- Part No.: T4202BT-J
 - Applicable wire: AWG#18-#22
 - Material: Brass
 - Finish: Tin-Plated
- The Dimension Marked “▼” Must Be Recorded

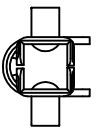

D	更新图面	2019-07-03	陈雄军							
C	修订版本	2018-07-09	陈雄军							
B	变更图宽格式内容	2013-12-27	陈雄军							
A	新版本	2011-05-24	陈雄军							
H	说明	日期	承认							
1	版次	REV.	APPRO.							
1	1	2	3	4	5	6	7	8	9	10

一般公差	0±0.30
GENERAL TOLERANCE:	.00±0.25
	.000±0.20
	.000±0.05
ANGLE: ±1°	
绘图/DR	陈雄军
审核/CHECK	陈雄军
批准/APPRO	胡进
日期/DATE	2019-07-03

<p>XYDZ® 东莞市祥运连接器有限公司</p> <p>Connectors Dongguan Xiangyun Connector s CO., Ltd</p>	
投影法 Projection	品名 (PART NAME)
单位 Unit	料号 (PART NO)
比例/Scale	Terminal Connector Series
大小/Size	Molex 4.20mm Female
页码/Sheet	T4202BT-J
版本/Rev	D
	状态码
	C