

ROHS

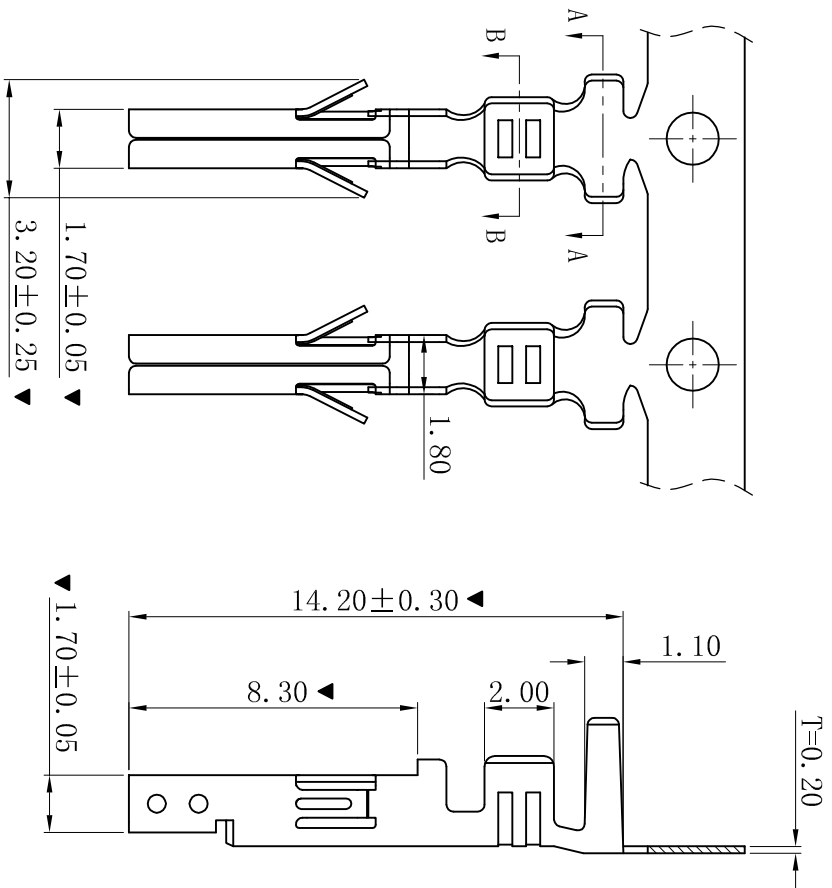

SECTION: A-A

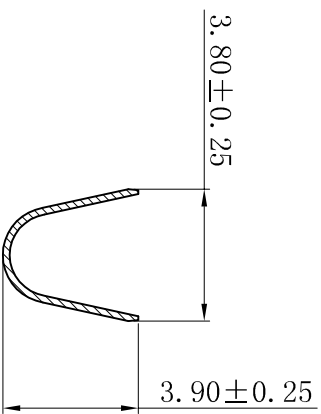

SECTION: B-B

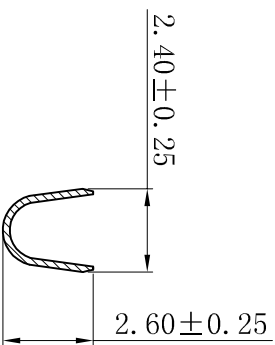

- SPECIFICATIONS
- Voltage rating: 600V AC, DC
- Current rating: 7A, AC, DC
- Withstanding Voltage: 1500V AC/minute
- Temperature range: -25° C~+85° C
- Contact resistance: 20mΩ max
- TERMINAL
- Part No.: T4202BT-GJ-J
- Applicable wire: AWG#18-#24x2
- Material: Brass
- Finish: Tin Plated
- The Dimension Marked “▼” Must Be Recorded

更新图面		2019-07-03		陈雄军		一般公差 GENERAL TOLERANCE:		0±0.30 .0±0.25 .000±0.20 ANGLE: ±1°		投影法 Projection		品名 (PART NAME)		料号 (PART NO)		状态码	
修打版本		2018-07-09		陈雄军		绘图/DR		陈雄军		MM		Molex 4.20mm Female		T4202BT-GJ-J		C	
变更图览格式内容		2013-12-27		陈雄军		审核/CHECK		胡进		1:1		Terminal Connector Series					
新版本		2011-05-24		陈雄军		批准/APPRO		胡进		A4							
说明		日期		承认		日期/DATE		2019-07-03		1/1							
版次		DESCRPTION		APPRO.						页码/SHEET							
REV.		1								版本/Rev							

XYDZ® 东莞市祥运连接器有限公司
Dongguan Xiangyun Connectors Co., Ltd