

RoHS

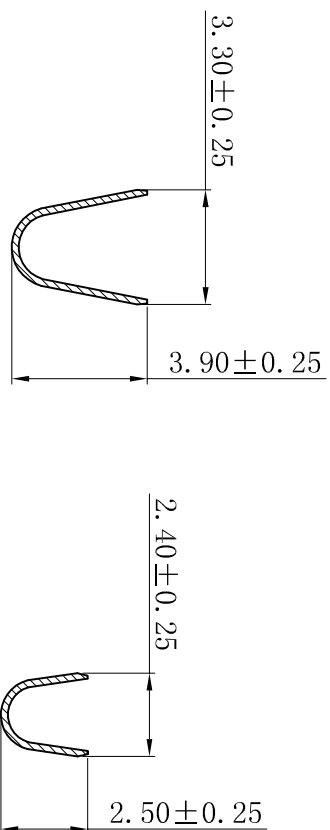
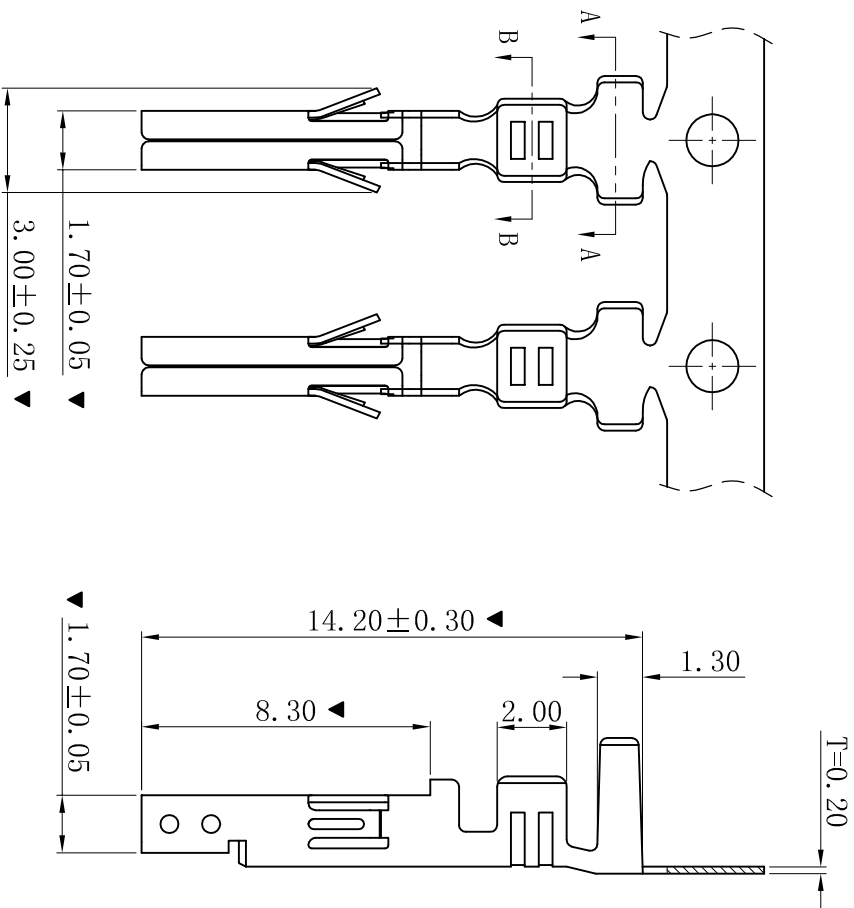

SECTION: A-A

SECTION: B-B

- SPECIFICATIONS
- Voltage rating: 600V AC, DC
- Current rating: 7A, AC, DC
- Withstanding Voltage: 1500V AC/minute
- Temperature range: -25°C~+85°C
- Contact resistance: 20mΩ max
- TERMINAL
- Part No.: T4202BT-GJ-H
- Applicable wire: AWG#18-#22
- Material: Brass
- Finish: Tin-Plated
- The Dimension Marked “▼” Must Be Recorded

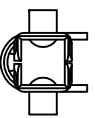

D		更新图面		2019-07-03	陈雄军	一般公差 GENERAL TOLERANCE: 0.1±0.30 .0±0.25 .00±0.20 .000±0.05 ANGLE: ±1°		投影法 Projection		品名 (PART NAME)		Molex 4.20mm Female Terminal Connector Series	料号 (PART NO.)	T4202BT-GJ-H	状态码 C
C		修订版本		2018-07-09	陈雄军	绘图/DR		单位 Unit		(PART NAME)					
B		变更图规格式内容		2013-12-27	陈雄军	审核/CHECK		比例/Scale		(PART NAME)		大小/Size		T4202BT-GJ-H	
A		新版本		2011-05-24	陈雄军	核准/APPRO		页码/Sheet		(PART NAME)		页码/Sheet		T4202BT-GJ-H	
H		说明		日期	承认	日期/DATE		版本/Rev		(PART NAME)		版本/Rev		T4202BT-GJ-H	
G		DESCRPTION		DATE:	APPRO.	日期/DATE		版本/Rev		(PART NAME)		版本/Rev		T4202BT-GJ-H	
1		1		1		1		1		1		1		1	

XYDZ® 东莞市祥运连接器有限公司
Dongguan Xiangyun Connector s CO., Ltd