

ROHS

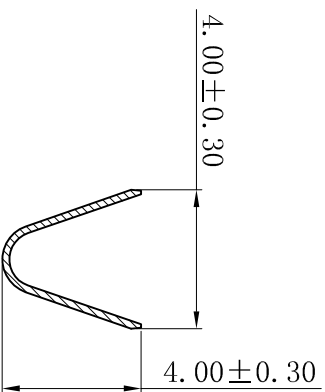

SECTION: A-A

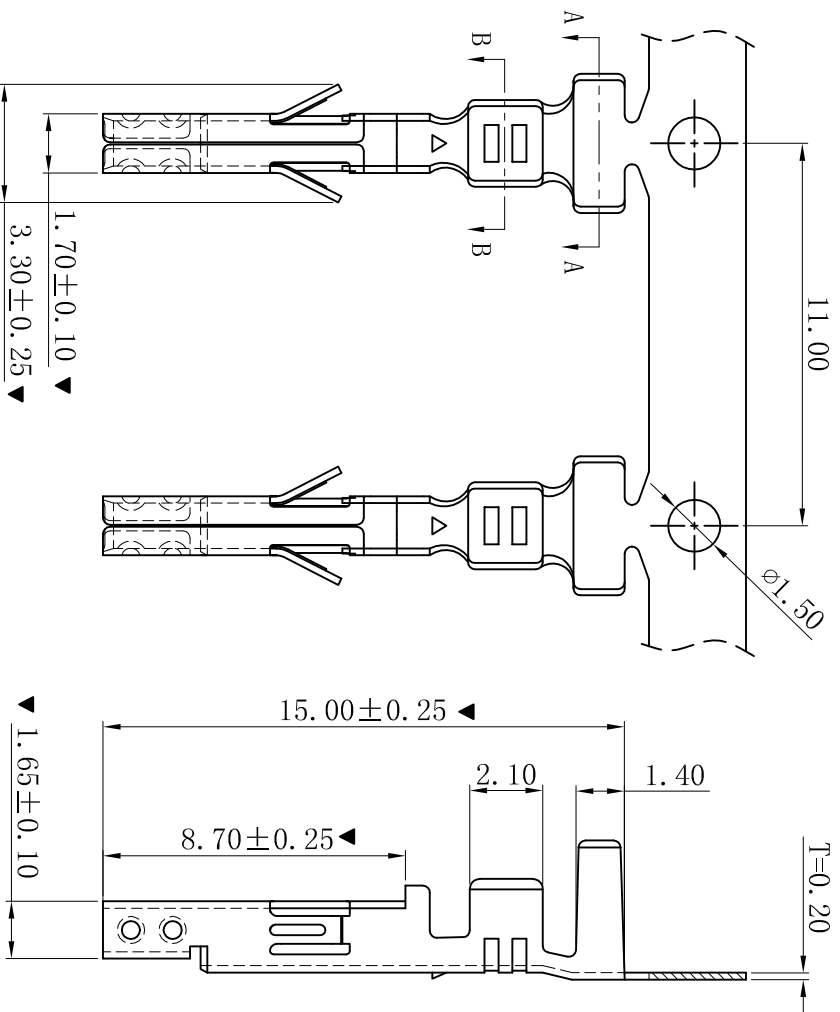
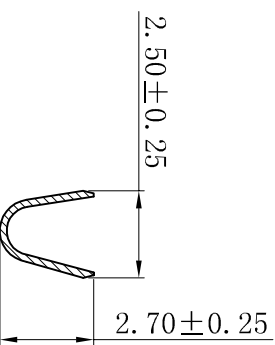

SECTION: B-B

- SPECIFICATIONS
- Voltage rating: 600V AC, DC
 - Current rating: 7A, AC, DC
 - Withstanding Voltage: 1500V AC/minute
 - Temperature range: -25°C~+85°C
 - Contact resistance: 20mΩ max
- TERMINAL
- Part No.: T4202BT-GJ-CD-24H
 - Applicable wire: AWG#18-#22
 - Material: Brass or Phosphor Bronze
 - Finish: Tin Plated Stamping before plating
 - The Dimension Marked “▼” Must Be Recorded

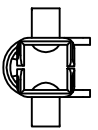

D	更新图面	2019-07-03	陈雄军	更新图面
C	修订版本	2018-07-09	陈雄军	变更图宽格式内容
B	新版本	2013-12-27	陈雄军	新版本
A	说明	2011-05-24	陈雄军	说明
H	版次	REV.	1	1

一般公差		0±0.30
GENERAL TOLERANCE:		.00±0.25
		.000±0.20
		.000±0.05
ANGLE: ±1°		
绘图/DR	陈雄军	2019-07-03
审核/CHECK	陈雄军	
批准/APPRO	胡进	
日期/DATE	2019-07-03	

<p>XYDZ® 东莞市祥运连接器有限公司 Dongguan Xiangyun Connector s CO., Ltd</p>	
投影法 Projection	
单位 Unit	MM
比例/Scale	1:1
大小/Size	A4
页码/SHEET	1/1
版本/Rev	D
品名 (PART NAME)	Molex 4.20mm Female Terminal Connector Series
料号 (PART NO)	T4202BT-GJ-CD-24H
状态码	C