

ROHS

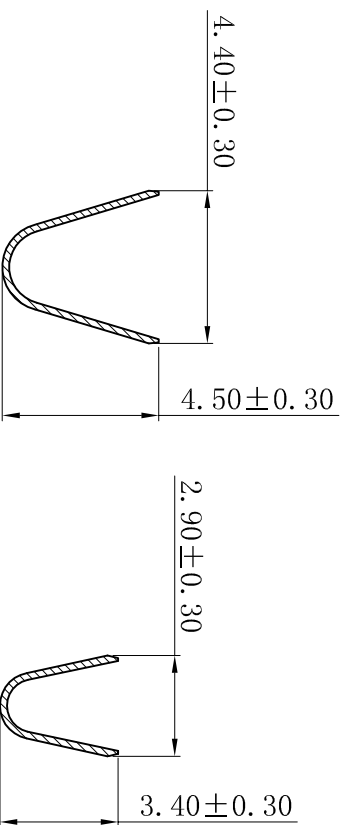

- SPECIFICATIONS
- Voltage rating: 600V AC, DC
- Current rating: 7A, AC, DC
- Withstanding Voltage: 1500V AC/minute
- Temperature range: -25°C~+85°C
- Contact resistance: 20mΩ max
- TERMINAL
- Part No.: T4202BT-CGJ-B-D
- Applicable wire: AWG#14
- Material: Brass or Phosphor Bronze
- Finish: Tin-Plated
- The Dimension Marked “▼” Must Be Recorded

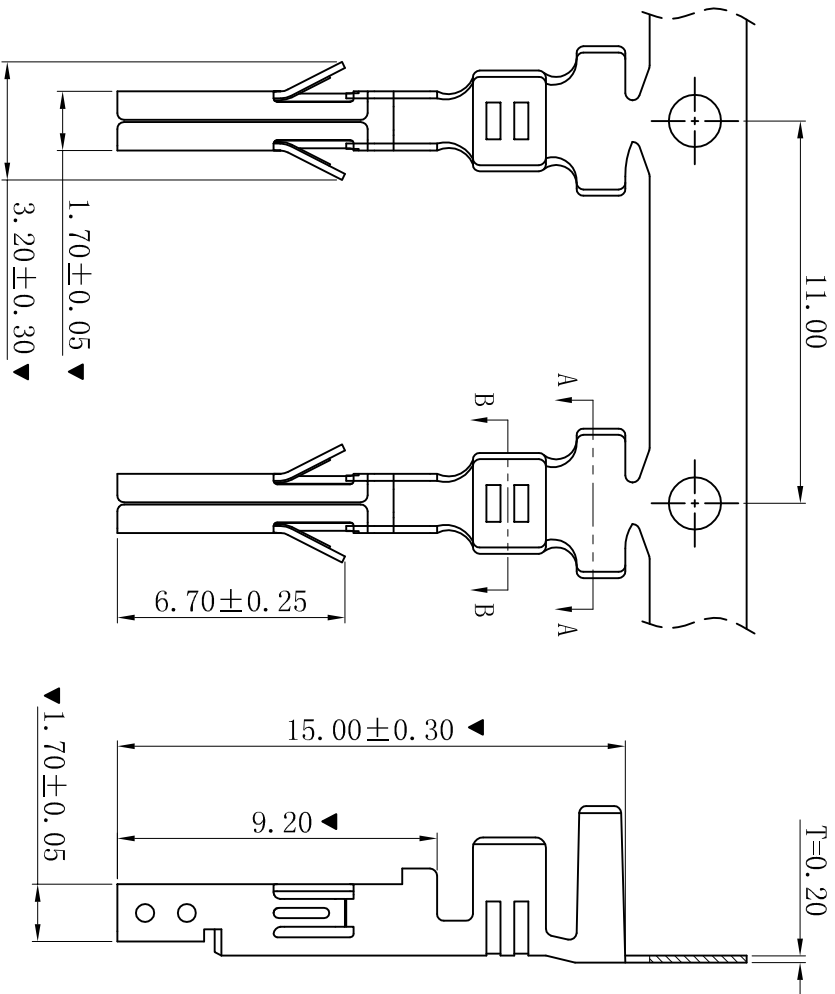
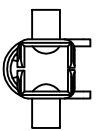

D	更新图面	2019-07-03	陈雄军	一般公差 GENERAL TOLERANCE: 0±0.30 .0±0.25 .00±0.20 .000±0.05 ANGLE: ±1°	绘图/DR 审核/CHECK 批准/APPRO	陈雄军 陈雄军 胡进	投影法 Projection 单位 Unit MM 比例/Scale 1:1 大小/Size A4 页码/Sheet 1/1 版本/Rev D	品名 (PART NAME) 料号 (PART NO)	Molex 4.20mm Female Terminal Connector Series T4202BT-CGJ-B-D	状态码 C
C	修订版本	2018-07-09	陈雄军							
B	变更图宽格式内容	2013-12-27	陈雄军							
A	新版本	2011-05-24	陈雄军							
H	说明 DESCRIPTION	日期 DATE	承认 APPRO.							
1	版次 REV.									

XYDZ® 东莞市祥运连接器有限公司
Dongguan XiangYun Connector s CO., Ltd