

ROHS

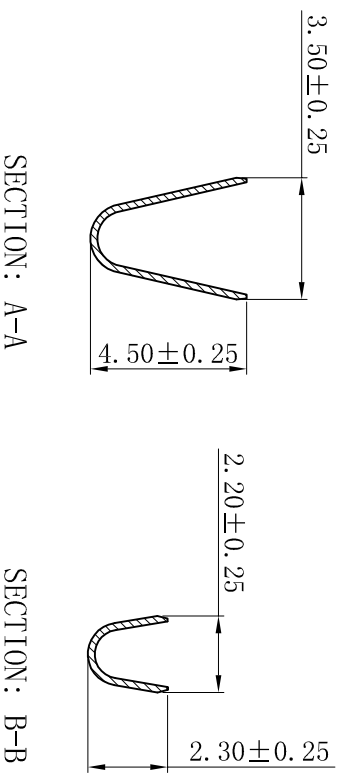

- SPECIFICATIONS
- Voltage rating: 600V AC, DC
 - Current rating: 7A, AC, DC
 - Withstanding Voltage: 1500V AC/minute
 - Temperature range: -25°C~+85°C
 - Contact resistance: 20mΩ max
- TERMINAL
- Part No.: T4201BT-CGJ-J
 - Applicable wire: AWG#16-#18-#24x2
 - Material: Brass
 - Finish: Tin-Plated
 - The Dimension Marked “▼” Must Be Recorded

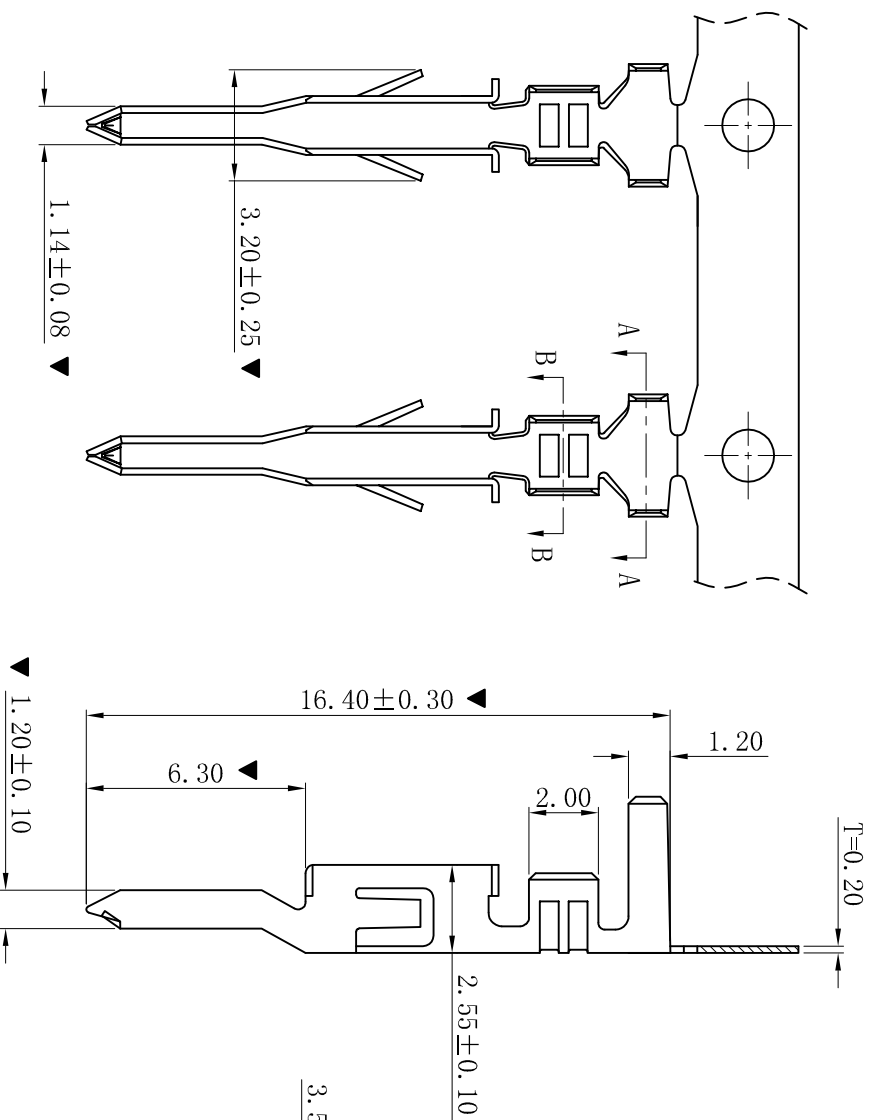
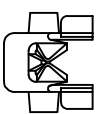

| | | | | | | | | | | | | |
|------------|--|------------|--------|--|--|------------------------------------|--|---|--|----------------------------------|--|----------|
| 更新图面 | | 2019-07-03 | 陈雄军 | 一般公差 GENERAL TOLERANCE: 0±0.30 .0±0.25 .00±0.20 .000±0.05 ANGLE: ±1° | | 投影法 Projection 单位 Unit MM | | 品名 (PART NAME) Molex 4.20mm Male Terminal Connector Series | | 料号 (PART NO) T4201BT-CGJ-J | | 状态码 C |
| 修訂板本 | | 2018-07-09 | 陈雄军 | 绘图/DR 审核/CHECK 陈雄军 | | 大小/Size A4 | | | | | | |
| 变更图宽格式内容 | | 2013-12-27 | 陈雄军 | 核准/APPRO 胡进 | | 页码/SHEET 1/1 | | | | | | |
| 新版本 | | 2011-05-24 | 陈雄军 | 日期/DATE 2019-07-03 | | 版本/Rev D | | | | | | |
| 说明 | | | 承认 | 日期/DATE | | | | | | | | |
| DESCRPTION | | | APPRO. | | | | | | | | | |
| 版次 | | | | | | | | | | | | |
| REV. | | | | | | | | | | | | |

XYDZ® 东莞市祥运连接器有限公司
Dongguan Xiangyun Connectors CO., Ltd