

ROHS

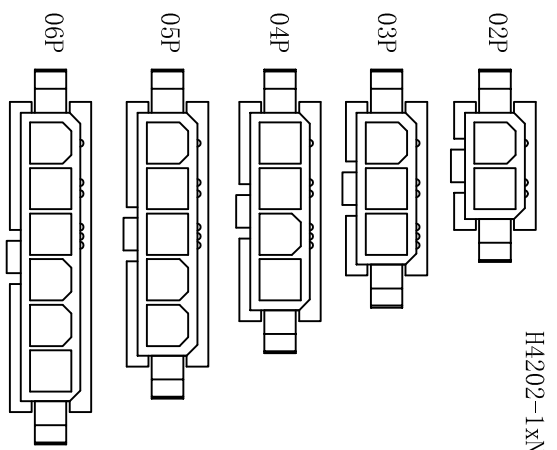
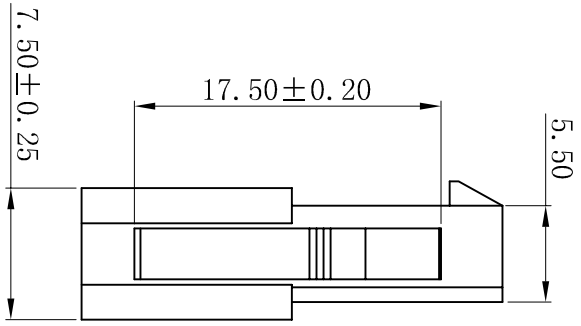
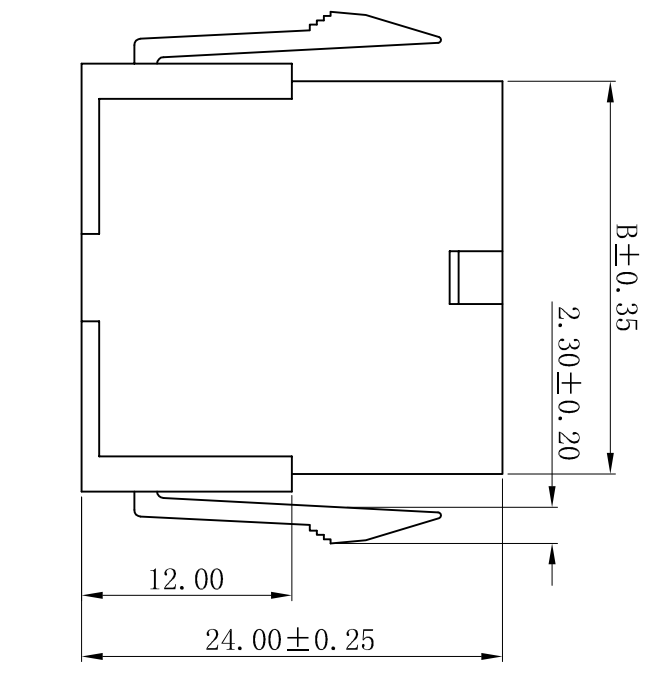
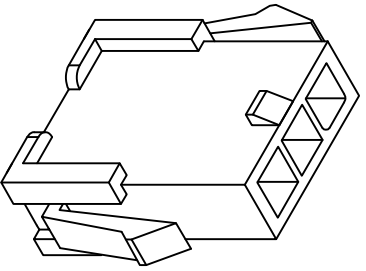
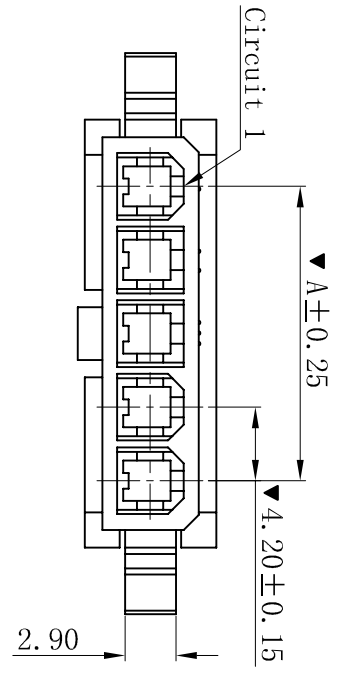

Part No.	Dimensions (mm)	
	A	B
02	4.20	9.80
03	8.40	14.00
04	12.60	18.20
05	16.80	22.40
06	21.00	26.60

- SPECIFICATIONS
- Voltage rating: 600V AC, DC
  - Current rating: 7A, AC, DC
  - Withstanding Voltage: 1500V AC/minute
  - Insulation resistance: 1000MΩ min
  - Temperature range: -25° C~+85° C
- HOUSING
- Part No.: H4202-1xNP-X
  - Poles: 02-06P
  - Housing Material: PA66 UL94V-2 or UL94V-0
  - Mates With: H4201 Single Row Receptacle
  - Use With: T4201 Terminals
  - The Dimension Marked "▲" Must Be Recorded

D	更新图面	2019-07-03	陈雄军	一般公差 GENERAL TOLERANCE: 0±0.30 .0±0.25 .00±0.20 .000±0.05 ANGLE: ±1°	陈雄军	胡进	2019-07-03
C	修订版本	2015-11-04	陈雄军	绘图/DR	陈雄军	胡进	2019-07-03
B	变更图宽格式内容	2013-12-27	陈雄军	审核/CHECK	陈雄军	胡进	2019-07-03
A	新版本	2011-05-24	陈雄军	批准/APPRO	陈雄军	胡进	2019-07-03
H	版次 REV.	说明 DESCRIPTION	日期 DATE	承认 APPRO.	日期 DATE	承认 APPRO.	日期 DATE

**XYDZ® 东莞市祥运连接器有限公司**  
Dongguan Xiangyun Connector s CO., Ltd

投影法  
Projection

单位 Unit  
MM

比例/Scale  
1:1

大小/Size  
A4

页码/SHEET  
1/1

版本/Rev  
D

品名  
(PART NAME)  
Molex 4.20mm Female Housing  
Connector Series

料号  
(PART NO)  
H4202-1xNP-X

状态码  
C