

ROHS

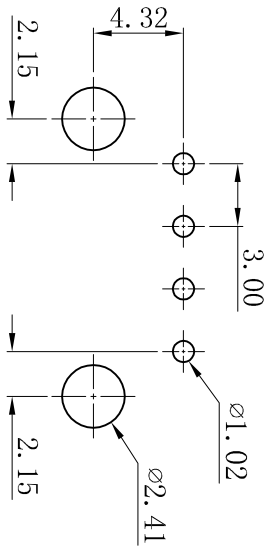

P.C.B. LAYOUT
TOLERANCE: ±0.05mm

- SPECIFICATIONS**
- Voltage rating: 250V AC, DC
 - Current rating: 5A, AC, DC
 - Withstanding Voltage: 1500V AC/minute
 - Insulation resistance: 1000MΩ min
 - Temperature range: -25°C ~ +85°C
 - Contact resistance: 20mΩ max
- WAFER**
- Part No.: W3045RD-NP
 - Poles: 02-12P
 - Housing Material: PA66 15%GF UL94V-0 Black
 - Ter Material: Brass
 - Solder Tabs Material: Brass
 - Contact Area Plating: Tin-Plated
 - The Dimension Marked "▼" Must Be Recorded

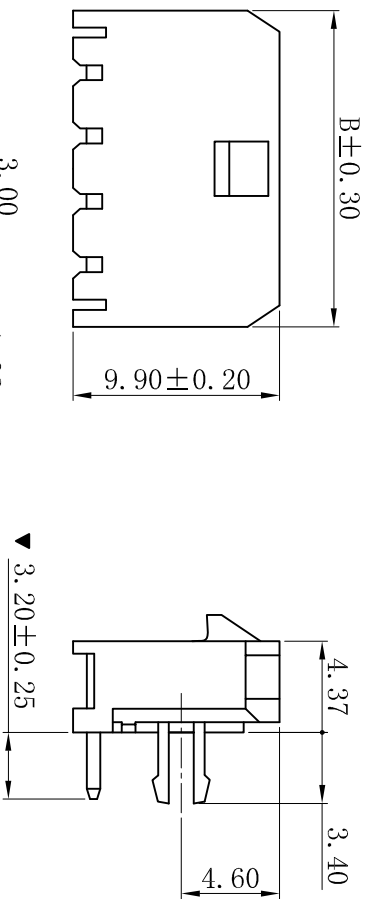
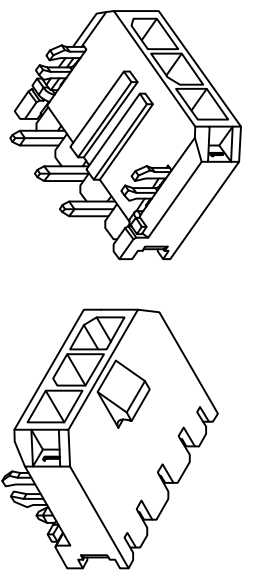
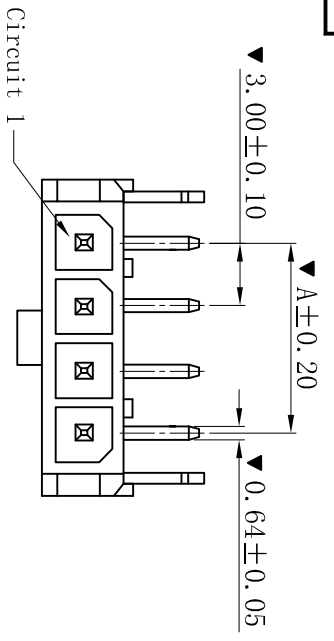
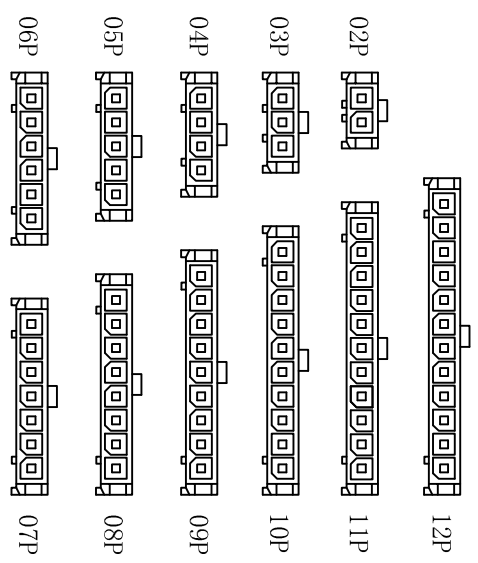

Poles	Dimensions (mm)	
	A	B
02	3.00	9.65
03	6.00	12.65
04	9.00	15.65
05	12.00	18.65
06	15.00	21.65
07	18.00	24.65
08	21.00	27.65
09	24.00	30.65
10	27.00	33.65
11	30.00	36.65
12	33.00	39.65

CIRCUIT SIZE LAYOUT

XYDZ® 东莞市祥运连接器有限公司
Dongguan XiangYun Connectors CO., Ltd

一般公差 GENERAL TOLERANCE:	±0.30 .0±0.25 .00±0.20 .000±0.05
ANGLE: ±1°	

D	更新图面	2019-06-03	陈雄军
C	修订版本	2015-11-04	陈雄军
B	变更图宽格式内容	2013-12-27	陈雄军
A	新版本	2011-05-24	陈雄军
H	说明 DESCRPTION	日期 DATE:	承认 APPRO.
1			
2			
3			
4			
5			
6			
7			
8			
9			
10			

投影法 Projection	第一角
单位 Unit	MM
比例/Scale	1:1
大小/Size	A4
页码/Sheet	1/1
版本/Rev	D
品名 (PART NAME)	Molex 3.0mm DIP 90° 鱼叉式 Wafer Connector Series
料号 (PART NO)	W3045RD-NP
状态码	C