

ROHS

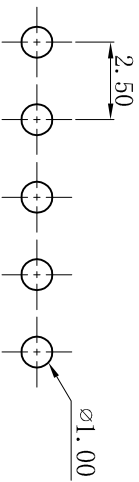
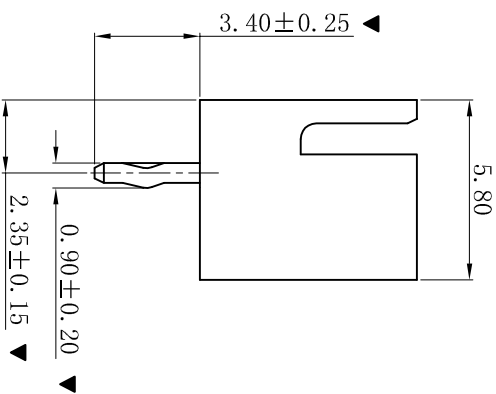
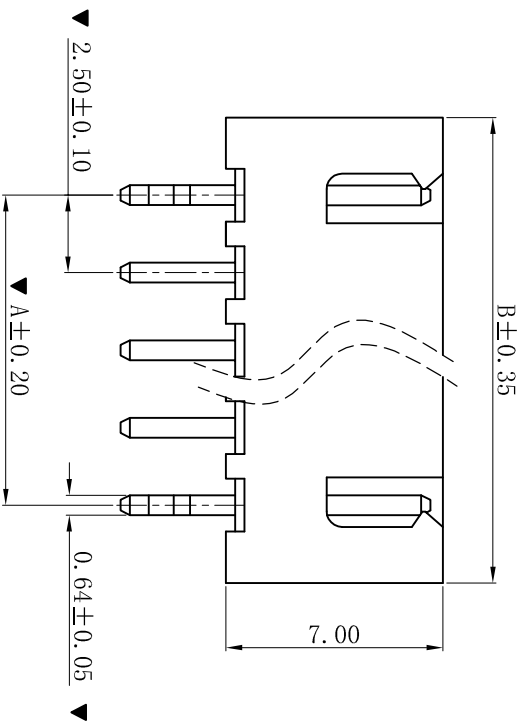
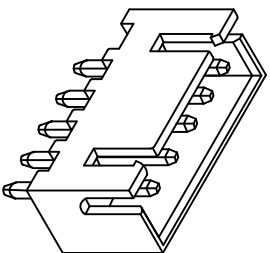
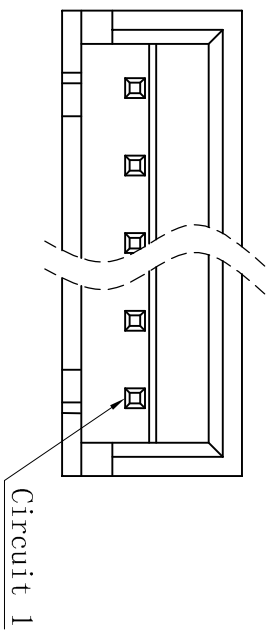

P. C. B. LAYOUT

■ SPECIFICATIONS

- Voltage rating: 250V AC, DC
- Current rating: 3A, AC, DC
- Withstanding Voltage: 1000V AC/minute
- Insulation resistance: 1000M $\Omega$  min
- Temperature range: -25° C ~ +85° C
- Contact resistance: 20m $\Omega$  max

■ WAFER

- Part No. : W2501V-NP-46
- Poles : 02/04/06/08P
- Housing Material: PA46 UL94V-0
- Pin Material: Brass
- Contact Area Plating: Tin-Plated
- The Dimension Marked “▼” Must Be Recorded

Poles	Dimension (mm)	
	A	B
02	2.50	7.50
04	7.50	12.50
06	12.50	17.50
08	17.50	22.50

D	更新图面	2019-06-03	陈雄军	一般公差 GENERAL TOLERANCE: 0±0.30 .0±0.25 .00±0.20 .000±0.05 ANGLE: ±1°	绘图/DR 审核/CHECK 核准/APPRO	胡进	日期/DATE	2019-06-03
C	修订版本	2015-11-04	陈雄军	变更图宽格式内容	陈雄军	陈雄军	日期	2015-11-04
B	新版本	2011-05-24	陈雄军	说明	陈雄军	陈雄军	日期	2011-05-24
A	版次	1	陈雄军	说明	陈雄军	陈雄军	日期	2011-05-24

**XYDZ® 东莞市祥运连接器有限公司**  
Dongguan XiangYun Connectors CO., Ltd

投影法: 品名: XH 2.50mm 180° Wafer  
单位: MM (PART NAME)  
比例/Scale: 1:1  
大小/Size: A4  
页码/SHEET: 1/1  
版本/Rev: D  
料号: W2501V-NP-46 (PART NO)  
状态码: C