

RoHS

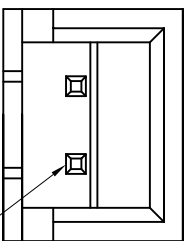

Circuit 1

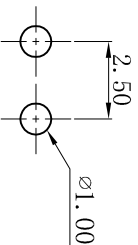
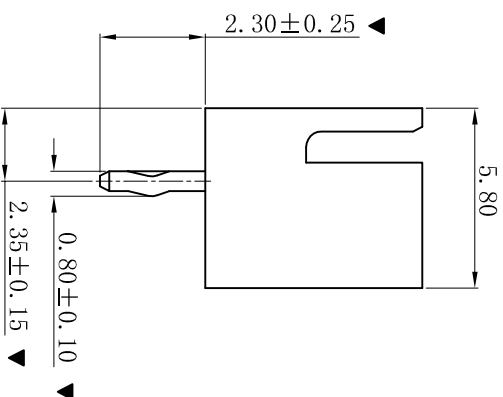
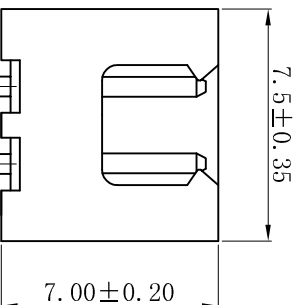

P. C. B. LAYOUT

- SPECIFICATIONS
- Voltage rating: 250V AC, DC
  - Current rating: 3A, AC, DC
  - Withstanding Voltage: 1000V AC/minute
  - Insulation resistance: 1000M $\Omega$  min
  - Temperature range: -25 $^{\circ}$ C~+85 $^{\circ}$ C
  - Contact resistance: 20m $\Omega$  max
- WAFER
- Part No.: W2501V-02P-WL2.3
  - Poles : 02P
  - Housing Material: PA66 UL94V-0
  - Pin Material: Brass
  - Contact Area Plating: Tin-Plated
  - The Dimension Marked “▼” Must Be Recorded

更新图面		2019-06-03		PPA-Duwan		一般公差 GENERAL TOLERANCE:		0±0.30 .0±0.25 .00±0.20 .000±0.05		投影法 Projection		品名 (PART NAME)		XH 2.50mm 180° Wafer Connector Series	
新版本		2018-05-25		柏运奇		ANGLE: ±1°		.00±0.25 .000±0.05		单位 Unit		料号 (PART NO)		W2501V-02P-WL2.3	
说明 DESCRIPTION		日期 DATE:		承认 APPRO.		日期/DATE		审核/CHECK		日期/DATE		页码/SHEET		版本号	
1		2		3		4		5		6		7		8	

XYDZ® 东莞市祥运连接器有限公司  
Dongguan XiangYun Connectors CO., Ltd

审核/DATE	胡进
审核/CHECK	陈雄军
审核/APPRO	胡进

单位	MM
比例/Scale	1:1
大小/Size	A4
页码/SHEET	1/1
版本/Rev	B

状态码  
C