

ROHS

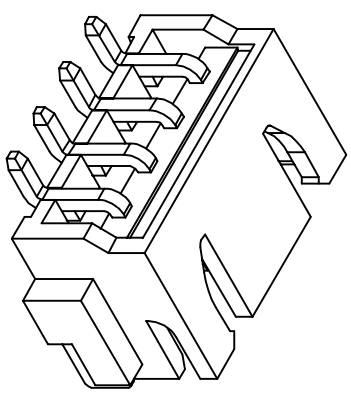
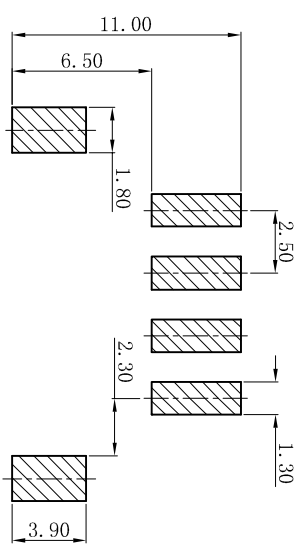
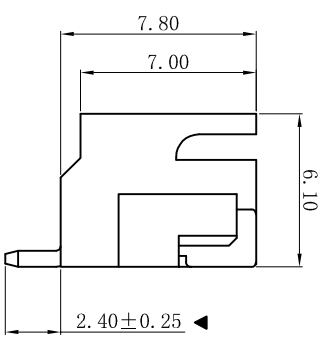
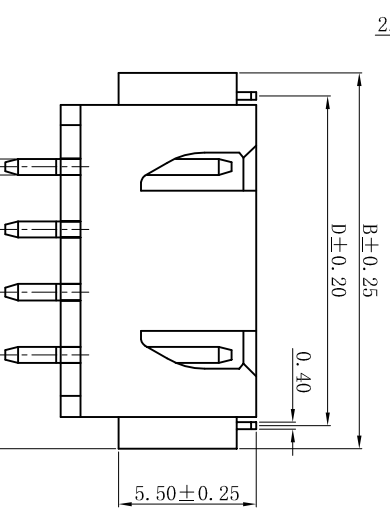
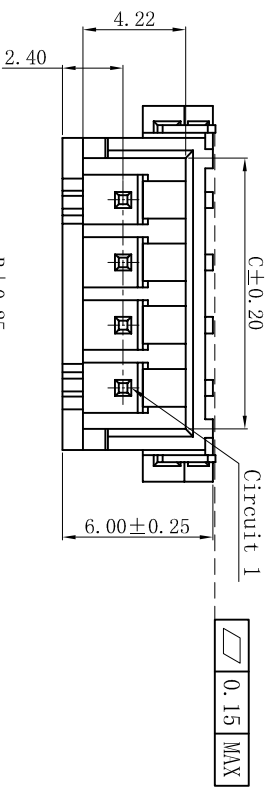

P. C. B. LAYOUT

■ SPECIFICATIONS

- Voltage rating: 250V AC, DC
- Current rating: 3A, AC, DC
- Withstanding Voltage: 1000V AC/minute
- Insulation resistance: 1000MΩ min
- Temperature range: -25° C~+85° C
- Contact resistance: 20mΩ max

■ WAFER

- Part No.: W2501SR-NP-JK
- Poles : 02-16P
- Housing Material: LCP U94V-0
- Pin Material: Brass
- Contact Area Plating: Tin-Plated
- The Dimension Marked “▲” Must Be Recorded

Poles	Dimension (mm)			
	A	B	C	D
02	2.50	10.00	6.10	8.20
03	5.00	12.50	8.60	10.70
04	7.50	15.00	11.10	13.20
05	10.00	17.50	13.60	15.70
06	12.50	20.00	16.10	18.20
07	15.00	22.50	18.60	20.70
08	17.50	25.00	21.10	23.20
09	20.00	27.50	23.60	25.70
10	22.50	30.00	26.10	28.20
11	25.00	32.50	28.60	30.70
12	27.50	35.00	31.10	33.20
13	30.00	37.50	33.60	35.70
14	32.50	40.00	36.10	38.20
15	35.00	42.50	38.60	40.70
16	37.50	45.00	41.10	43.20

XYDZ® 东莞市祥运连接器有限公司
 Dongguan XiangYun Connectors CO., Ltd

一般公差 GENERAL TOLERANCE:	0±0.30 -0±0.25 .00±0.20 .000±0.05
ANGLE: ±1°	

更新图面	2019-06-03	陈雄军
修订版本	2015-11-04	陈雄军
变更图宽格式内容	2013-12-27	陈雄军
新版本	2011-05-24	陈雄军

版次 REV.	1	说明 DESCRIPTION	日期 DATE	承认 APPRO.
------------	---	-------------------	------------	--------------

投影法 Projection	第一角投影	品名 (PART NAME)	XH 2.50mm SMT 90° Wafer Connector Series		料号 (PART NO)	W2501SR-NP-JK	状态码 C
单位 Unit	MM	比例/Scale	1:1				
大小/Size	A4	页码/Sheet	1/1				
版本/Rev	D	日期/DATE	2019-06-03	审核/CHECK	胡进	日期/DATE	2019-06-03
		日期/DATE	2019-06-03	批准/APPRO	胡进	日期/DATE	2019-06-03
		日期/DATE	2019-06-03	承认/APPRO	陈雄军	日期/DATE	2019-06-03
		日期/DATE	2019-06-03	承认/APPRO	陈雄军	日期/DATE	2019-06-03