

ROHS

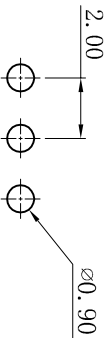
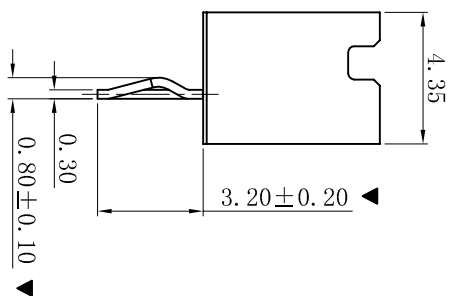
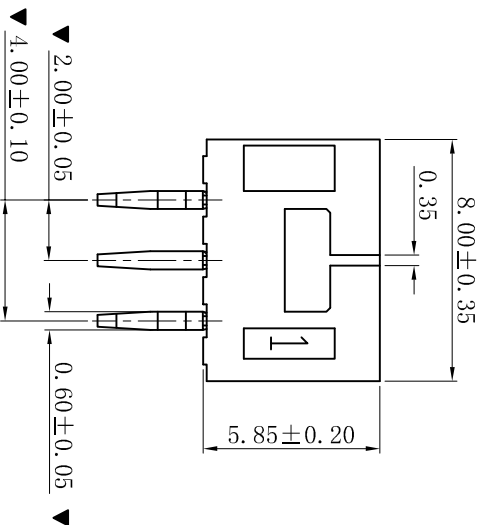
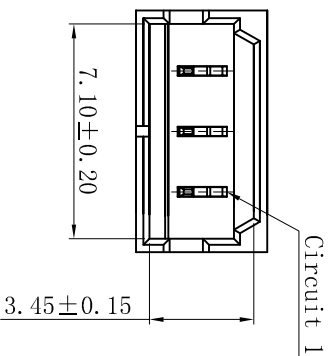

P. C. B LAYOUT

- SPECIFICATIONS**
- Voltage rating: 125V AC, DC
 - Current rating: 2A, AC, DC
 - Withstanding Voltage: 800V AC/minute
 - Insulation resistance: 1000M Ω min
 - Temperature range: -25 $^{\circ}$ C $^{\wedge}$ +85 $^{\circ}$ C
 - Contact resistance: 10m Ω max
- WAFER**
- Part No. : W2002V-03P-9T-WL3.2-B
 - Poles : 03P
 - Housing Material: PA9T UL94V-0
 - Pin Material: Brass
 - Contact Area Plating: Tin-Plated
 - The Dimension Marked “▼” Must Be Recorded

更新画面		2019-06-03		陈雄军		一般公差 GENERAL TOLERANCE: 0±0.30 .0±0.25 .00±0.20 .000±0.05 ANGLE: ±1 $^{\circ}$		XYDZ [®] 东莞市祥运连接器有限公司 Connectors Dongguan XiangYun Connectors CO., Ltd		投影法 Projection		品名 (PART NAME)		料号 (PART NO)		状态码			
修订版本		2015-11-04		陈雄军		绘图/DR		胡进		单位 Unit		Mollex 2.00mm 180 $^{\circ}$ 胶壳开槽 Wafer Connector Series		W2002V-03P-9T-WL3.2-B		C			
变更图览格式内容		2013-12-27		陈雄军		审核/CHECK		陈雄军		比例/Scale									
新版本		2011-05-24		陈雄军		批准/APPRO		胡进		大小/Size									
说明		日期		承认		日期/DATE		2019-06-03		页码/SHEET									
版次		DESCRPTION		APPRO.						版本/Rev		D							
1		2		3		4		5		6		7		8		9		10	