

RoHS

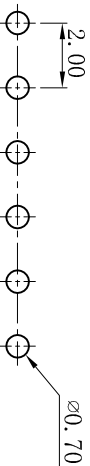
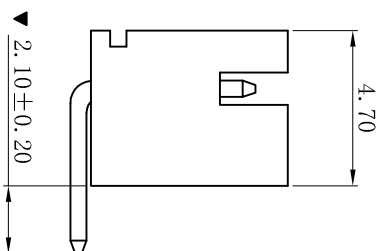
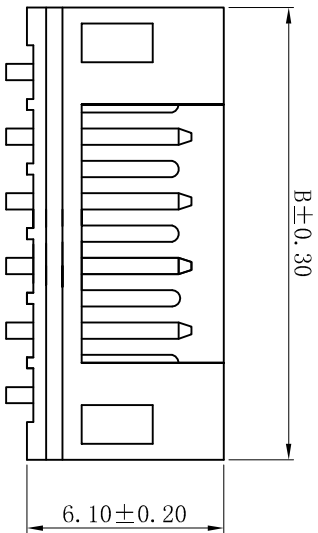
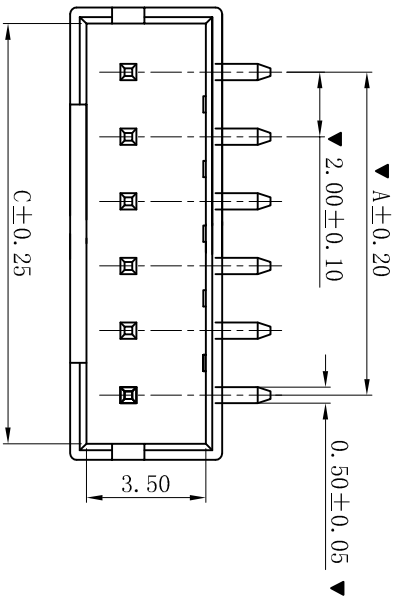

P.C.B LAYOUT

- SPECIFICATIONS**
- Voltage rating: 100V AC, DC
  - Current rating: 2A, AC, DC
  - Withstanding Voltage: 800V AC/minute
  - Insulation resistance: 1000MΩ min
  - Temperature range: -25° C~+85° C
  - Contact resistance: 20mΩ max
- WAFER**
- Part No.: W2001RB-NP-B-WL2.1
  - Poles : 02-16P
  - Housing Material: PA66 UL94V-0
  - Pin Material: Brass
  - Contact Area Plating: Tin-Plated
  - The Dimension Marked “▼” Must Be Recorded  
PIN L=0.50x10.30mm

Poles	Dimension (mm)		
	A	B	C
02	2.00	6.00	5.00
03	4.00	8.00	7.00
04	6.00	10.00	9.00
05	8.00	12.00	11.00
06	10.00	14.00	13.00
07	12.00	16.00	15.00
08	14.00	18.00	17.00
09	16.00	20.00	19.00
10	18.00	22.00	21.00
11	20.00	24.00	23.00
12	22.00	26.00	25.00
13	24.00	28.00	27.00
14	26.00	30.00	29.00
15	28.00	32.00	31.00
16	30.00	34.00	33.00

D	更新图面	2019-06-03	陈雄军
C	修訂版本	2015-11-04	陈雄军
B	变更图宽格式内容	2013-12-27	陈雄军
A	新版本	2011-05-24	陈雄军
H	说明	日期	承认
1	DESCRIPTION	DATE	APPRO.

一般公差	0±0.30
GENERAL TOLERANCE:	.00±0.25
	.000±0.20
ANGLE: ±1°	
绘图/DR	陈雄军
审核/CHK	陈雄军
批准/APPRO	胡进
日期/DATE	2019-10-12

**XYDZ® 东莞市祥运连接器有限公司**  
Dongguan XiangYun Connectors CO., Ltd

投影法: 单位: MM

比例/Scale: 1:1

大小/Size: A4

页码/Sheet: 1/1

版本/Rev: D

品名: PH 2.00mm 90° Wafer Connector Series

料号: W2001RB-NP-B-WL2.1

状态码: C