

RoHS

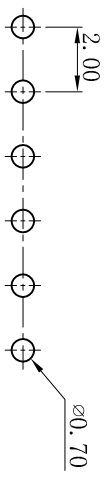
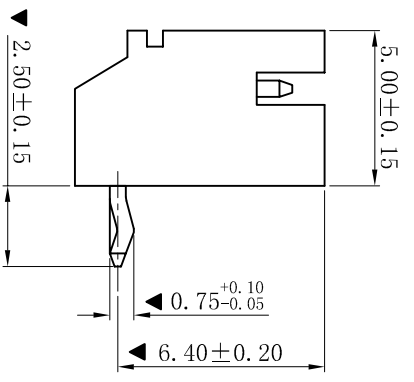
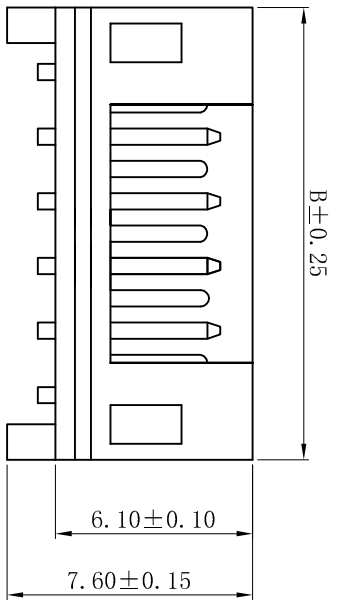
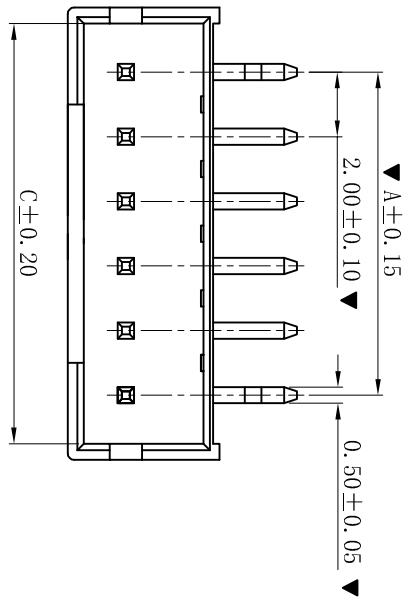

P.C.B LAYOUT

- SPECIFICATIONS
- Voltage rating: 100V AC, DC
 - Current rating: 2A, AC, DC
 - Withstanding Voltage: 800V AC/minute
 - Insulation resistance: 1000MΩ min
 - Temperature range: -25° C~+85° C
 - Contact resistance: 20mΩ max
- WAFER
- Part No.: W2001R-NP-WL2.5
 - Poles : 02-16P
 - Housing Material: PA66 UL94V-0
 - Pin Material: Brass
 - Contact Area Plating: Tin-Plated
 - The Dimension Marked “▼” Must Be Recorded
 - PIN L=0.50x10.50

Poles	Dimension (mm)		
	A	B	C
02	2.00	6.00	5.00
03	4.00	8.00	7.00
04	6.00	10.00	9.00
05	8.00	12.00	11.00
06	10.00	14.00	13.00
07	12.00	16.00	15.00
08	14.00	18.00	17.00
09	16.00	20.00	19.00
10	18.00	22.00	21.00
11	20.00	24.00	23.00
12	22.00	26.00	25.00
13	24.00	28.00	27.00
14	26.00	30.00	29.00
15	28.00	32.00	31.00
16	30.00	34.00	33.00

更新图画		2019-06-03	陈雄军	一般公差 GENERAL TOLERANCE: 0±0.30 .00±0.25 .000±0.05		投影法 Projection MM		品名 (PART NAME) PH 2.00mm 90° Wafer Connector Series	
修訂版本		2015-11-04	陈雄军	ANGLE: ±1°		大小/Scale 1:1		料号 (PART NO) W2001R-NP-WL2.5	
变更图宽格式内容		2013-12-27	陈雄军	绘图/DR		页码/SHEET 1/1		状态码 C	
新版本		2011-05-24	陈雄军	审核/CHKC		版本/Rev D			
说明		日期	承认	批准/APPRO		胡进			
DESCRPTION		DATE	APPRO.	日期/DATE		2019-06-03			

XYDZ® 东莞市祥运连接器有限公司
Dongguan XiangYun Connectors CO., Ltd