

RoHS

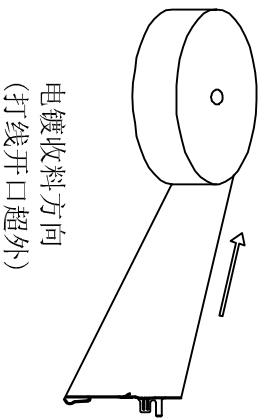
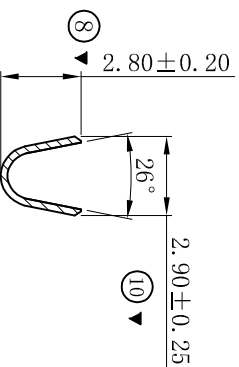
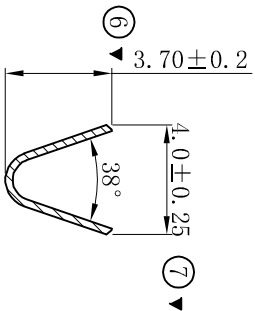
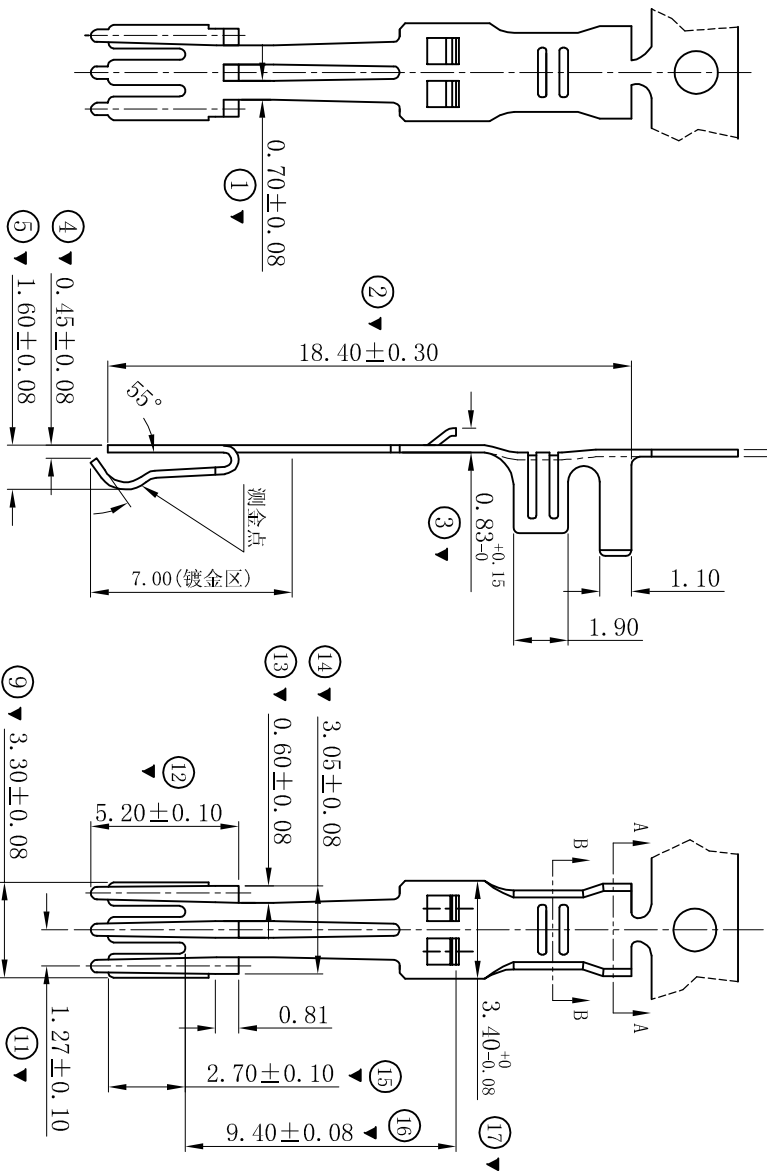

■ SPECIFICATIONS

- Voltage rating: 250V AC, DC
- Current rating: 7A, AC, DC
- Withstanding Voltage: 1500V AC/minute
- Temperature range: -25° C~+85° C
- Contact resistance: 20mΩ max

■ TERMINAL

- Part No.: T3810PG
- Applicable wire: AWG#18-#20
- Material: Phosphor Bronze
- Finish: Gold-Flash
- The Dimension Marked “▼” Must Be Recorded

Wire Range	Insulation OD	Qty/Reel
AWG#18--#20	2.10mm (Max)	5000pcs

注明:

1. 端子不可有氧化, 发黑, 压伤变形, 刮伤, 等不良.
2. 尺寸符合图面要求标有“▼”为重点尺寸

SECTION: A-A

SECTION: B-B

XYDZ® 东莞市祥运连接器有限公司
 Dongguan XiangYun Connectors CO., Ltd

Connectors

SATA1. 27mm 15P Terminal

投影法



Connector Series

一般公差



品名 (PART NAME)

GENERAL TOLERANCE:



料号 (PART NO)

0±0.30



T3810PG

±0.25



状态码

.00±0.20



C

.000±0.05



ANGLE: ±1°

