

ROHS

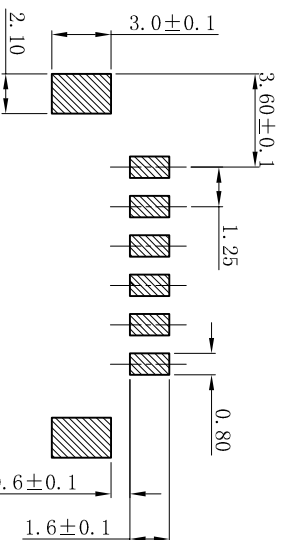
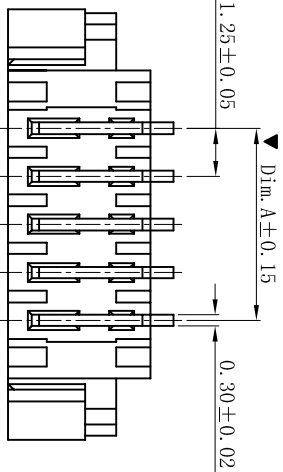
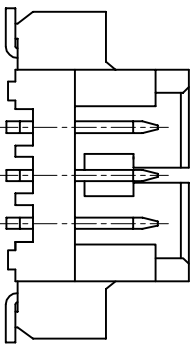
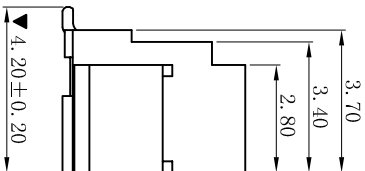
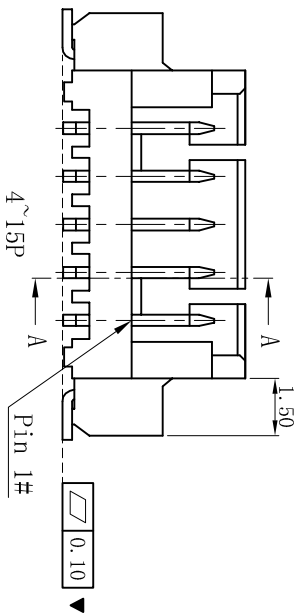
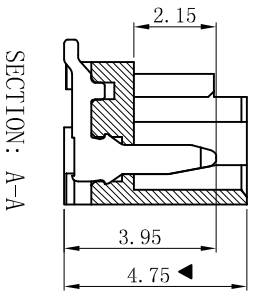
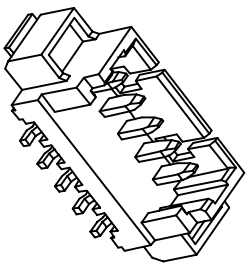
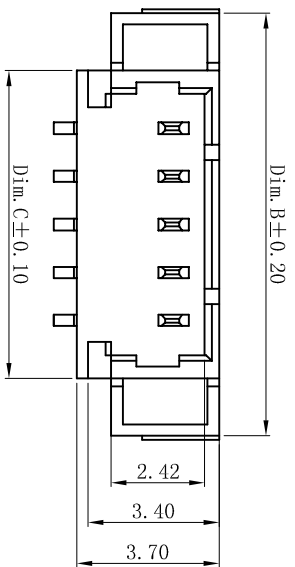

P.C.B LAYOUT: TOP VIEW
TOLERANCE: ±0.05mm

- SPECIFICATIONS
- Voltage Rating: 125V AC, DC
 - Current Rating: 1.0A, AC, DC
 - Withstanding Voltage: 250V AC/minute
 - Insulation Resistance: 100MΩ min
 - Temperature range: -25°C~+85°C
 - Contact resistance: 20mΩ max

■ WAFER

- Part No. : W1251SV-NP
- Poles : 02-15P
- Material : PA46 UL94V-0
- Pin Material : Phosphor Bronze /Tin-plated
- Solder Tab Material : Brass /Tin-plated
- The Dimension Marked “▼” Must Be Recorded

Poles	Dimensions (mm)		
	A	B	C
02	1.25	7.25	4.25
03	2.50	8.50	5.50
04	3.75	9.75	6.75
05	5.00	11.00	8.00
06	6.25	12.25	9.25
07	7.50	13.50	10.50
08	8.75	14.75	11.75
09	10.00	16.00	13.00
10	11.25	17.25	14.25
11	12.50	18.50	15.50
12	13.75	19.75	16.75
13	15.00	21.00	18.00
14	16.25	22.25	19.25
15	17.50	23.50	20.50

D	更新图面	2019-06-03	陈雄军
C	修订版本	2015-11-04	陈雄军
B	变更图宽格式内容	2013-12-27	陈雄军
A	新版本	2011-05-24	陈雄军
H	说明	日期	承认
1	版次	DESCRIPTION	APPRO.
2			
3			
4			
5			

一般公差
GENERAL TOLERANCE:
ANGLE: ±1°

XYDZ® 东莞市祥运连接器有限公司
Dongguan Xiangyun Connector s CO., Ltd

投影法 Projection	品名 (PART NAME)	Molex 1.25mm SMT 180° Wafer
单位 Unit	料号 (PART NO)	W1251SV-NP
比例/Scale 1:1	页码/SHEET 1/1	状态码 C
大小/Size A4	版本/Rev D	
审核/CHKC 陈雄军		
批准/APPRO 胡进		
日期/DATE 2019-06-03		

RoHS

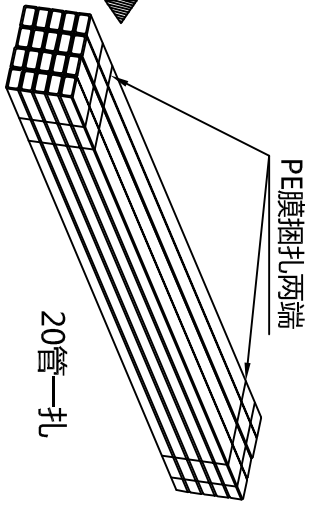
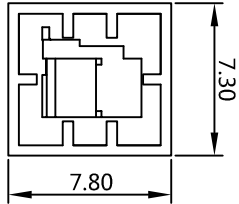
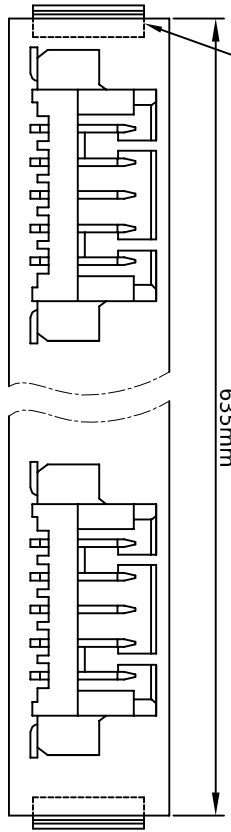
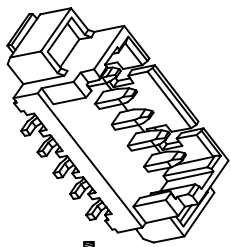

产品

真空管

PIN/位	PCS/管	管 内箱管数	PCS 内箱数量	PCS 一箱数量
2P	84	240	20160	40320
3P	71	240	17040	34080
4P	62	240	14880	29760
5P	55	240	13200	26400
6P	49	240	11760	23520
7P	45	240	10800	21600
8P	41	240	9840	19680
9P	38	240	9120	18240
10P	35	240	8400	16800
11P	33	240	7920	15840
12P	30	240	7200	14400
13P	29	240	6960	13920
14P	27	240	6480	12960
15P	26	240	6240	12480

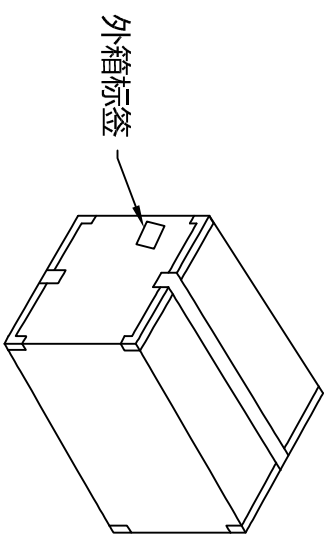

封箱(工字形)

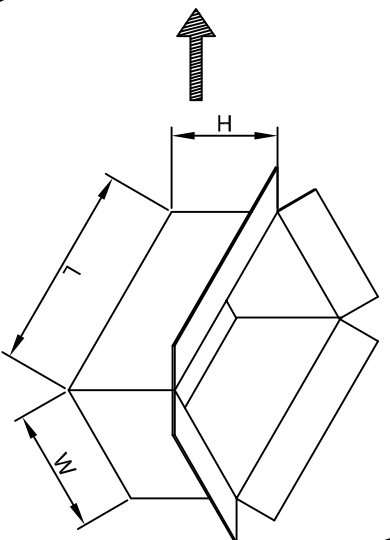

内箱规格
12扎装一内箱

包装说明:
 步骤1: 将产品按一管标准数量装入真空管内, 两头塞入白色软胶塞.
 步骤2: 将装好产品的真空管按20管一扎用PE膜捆扎两端.
 12扎装一内箱, 2内箱装一外箱封箱, 贴外箱标签.
 注: 不满一箱时, 需以填充物填充, 不可有晃动.

外箱规格:
66.0(L)x27.0(W)x15.5(H)CM

一般公差 GENERAL TOLERANCE:		0±0.50 .0±0.40 .00±0.30 .000±0.10	投影法 Projection		品名 (PART NAME)		Molex 1.25mm 1xNP SMT 180° 立式 Packaging Specification		状态码		
角度: ±1° ANGLE: ±1°			XYDZ® 东莞市祥运连接器有限公司 Dongguan XiangYun Connectors CO., Ltd		(PART NAME)		料号 (PART NO)		W1251SV-NP		
绘图/DR		PPA Duwa	单位 Unit		MM		大小/SIZE		A4		
审核/CHECK		陈雄军	比例/Scale		1:1		页码/SHEET		1/1		
日期/DATE		2019-06-15	核准/APPRO		胡进		版本/Rev		A		
说明 DESCRIPTION		新版本		日期/DATE		2019-06-15		承认 APPRO.		PPA Duwa	
版本 REV.		1		日期/DATE		2019-06-15		承认 APPRO.		PPA Duwa	