

RoHS

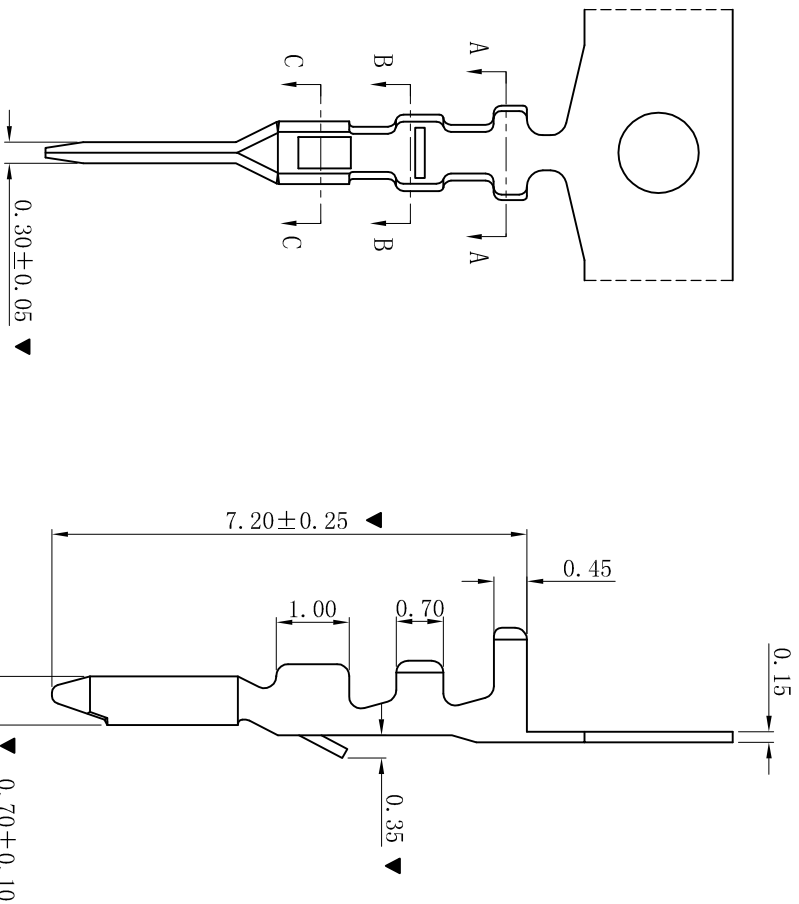

SECTION: A-A

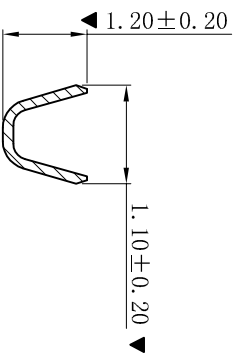

SECTION: B-B

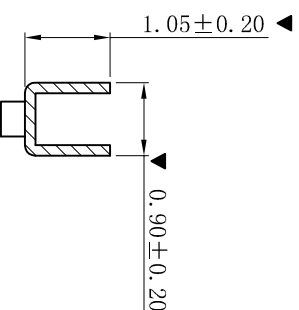

SECTION: C-C

- SPECIFICATIONS**
- Voltage rating: 125V AC, DC
 - Current rating: 1A, AC, DC
 - Withstanding Voltage: 250V AC/minute
 - Temperature range: -25°C~+85°C
 - Contact resistance: 20mΩ max
- TERMINAL**
- Part No.: T1251PT
 - Applicable wire: AWG#28-#32
 - Material: Phosphor Bronze
 - Finish: Tin-plated
 - The Dimension Marked “▼” Must Be Recorded
 - Reel: 15Kpcs

D	更新图面	2019-06-03	陈雄军	更新图面
C	修订版本	2015-11-04	陈雄军	变更图宽格式内容
B	新版本	2013-12-27	陈雄军	新版本
A	说明	2011-05-24	陈雄军	说明
H	版次	REV.	1	1

一般公差		0±0.30
GENERAL TOLERANCE:		.00±0.25
		.000±0.20
ANGLE: ±1°		.000±0.05
绘图/DR	陈雄军	胡进
审核/CHECK	陈雄军	胡进
批准/APPRO	陈雄军	胡进
日期/DATE	2019-06-03	

<p>XYDZ® 东莞市祥运连接器有限公司 Dongguan Xiangyun Connector s CO., Ltd</p>		<p>投影法 Projection 单位 Unit MM</p>	<p>品名 (PART NAME) Molex 1.25mm Male Terminal Connector Series</p>
料号 (PART NO)	T1251PT	页码/SHEET 1/1	状态码 C